

SIGN WARE



WALLS+
FORMS_{UN}

INTERIOR SIGNAGE SOLUTIONS EDITION 2.1

FOR FLOOR

FOR WALL

FOR CEILING



| | |
|--------------------------------|-------|
| About Us | 3 |
| EuroSign Family | 4-5 |
| Marquee Frame | 6 |
| LED Light Panel | 7 |
| DisplayFrame™ | 8-9 |
| SeküreFrame™ | 10-11 |
| Graphic Holders | 12-13 |
| 2-Way Frame | 14 |
| 4-Way Frame | 15 |
| Sign Stand | 16-17 |
| Graphic Stand | 18 |
| Euro Stand | 19 |
| WindFrame | 20 |
| Sandwichboard | 21 |
| Bulletin Holders | 22 |
| Banner Stand | 23 |
| SignWare | 24-25 |
| Profile header | 26 |
| Header signs | 27 |
| Components | 28-29 |
| Lights Alive | 30-31 |
| Versaflex Modular Frame System | 32 |
| Lights Thief | 33 |
| Single Sided Lightbox | 34-35 |
| Double Sided Lightbox | 36-37 |
| Backlit Floor Stand | 38-39 |

We appreciate the opportunity to send you our latest catalog. This book will illustrate our diversified range of signware products and accessories. Since our beginning Walls+Forms, Inc. has been guided by one simple belief; *"Manufacturing Flexibility Means Choices"*. We have over two decades of product design as well as manufacturing experience, and are recognized for our competitively priced high quality display solutions. Whether you are a retailer, product manufacturer, OEM, contractor or distributor, you have the ability to choose an ensemble of products crafted to your specifications. Whether you are looking for a specific promotional display or particular assemblies and parts; we have you covered.

We encourage you to browse through this entire brochure, as we offer a wide range of sign display solutions for all of your visual merchandising challenges. Our range of products includes two styles of front loading aluminum and plastic frames, suspended graphic holders for ceilings and windows, various free-standing sign display options for both interior and exterior applications and a full line of signage accessories and components. Thank you.

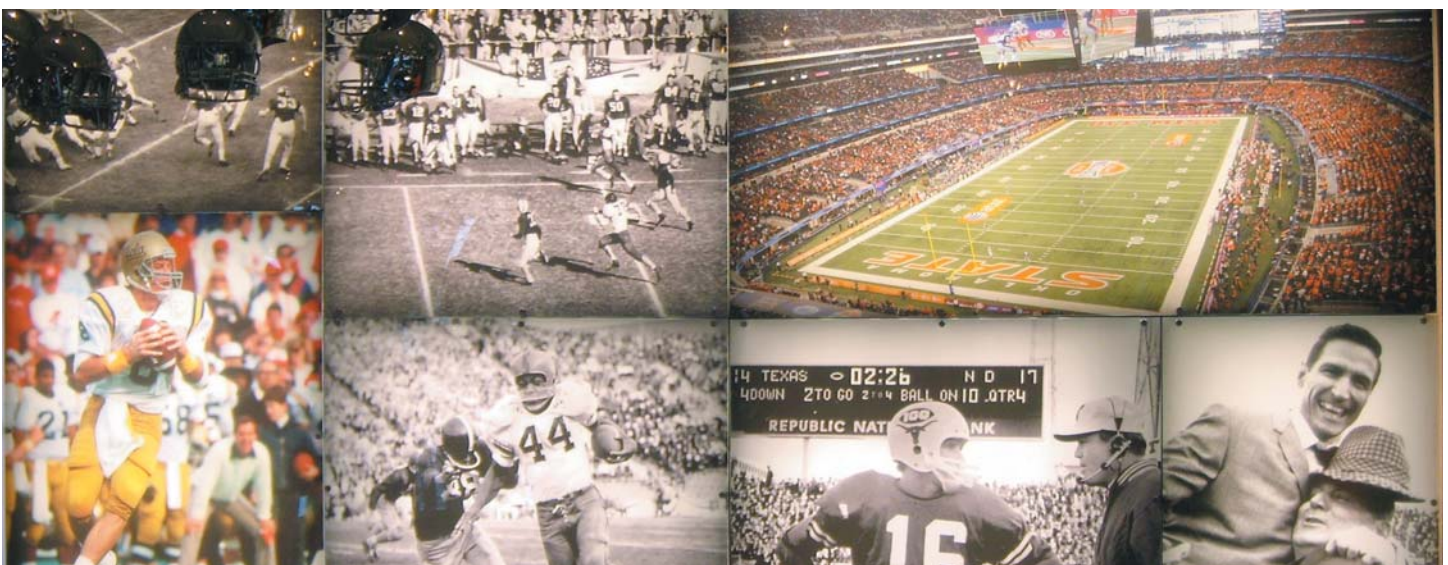



EUROSIGN™
FAMILY



MARQUEE FRAME
LED LIGHT PANEL
DISPLAYFRAME™
SEKÜREFRAME™
GRAPHIC HOLDERS
2-WAYFRAME
4-WAYFRAME



WALLS+
FORMS

MARQUEE FRAME

A USER FRIENDLY FRONT-LOADING FRAME

The Marquee Frame is a “user-friendly” front-loading graphic frame system manufactured for the signage professional. The modern contour frame boldly outlines your graphic creating more attention to your message and product brand. Specifically designed for large graphics, Marquee holds graphic securely along the entire perimeter.

Available in Anodized aluminum and black Finishes. Custom colors are also available, minimums may apply.

- Snap-open, snap closed rails make it simple to change graphics
- Rounded edges create a bold contemporary look
- Available in bright satin and classic black finishes
- Custom colors are also available (minimums may apply)
- Snaps securely into graphic face holding in firmly in place

Variety of back insert panels are available, including natural finish, white laminate, marker board, corrugated plastic, peg board, and LED light panels with exclusive 3D-crystal acrylic lens. Designed for interior and exterior graphic applications. The sleek, all aluminum profile can enhance any signage installation. It's round, beveled edges flow into each precision mitered corner creating a look that is uniquely new and innovative.

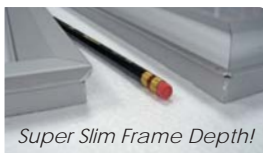

| ITEM# | GRAPHIC SIZE |
|---------|--------------|
| B0-1600 | 36"w x 48"h |
| B1-1601 | 30"w x 40"h |
| B2-1602 | 24"w x 36"h |
| C1-1605 | 22"w x 28"h |
| C2-1606 | 24"w x 24"h |
| C3-1607 | 20"w x 20"h |
| B3-1603 | 18"w x 24"h |
| B4-1604 | 11"w x 14"h |
| B5-1609 | 8½"w x 11"h |



SPECIFICATIONS

Colors / Finishes:

Clear Satin Anodized and Black Anodized finish 3 mil.

Note: Other colors are available; minimums may apply.

Corners:

Factory mitered for precise clean edges.

Backer Board Options:

The standard backer:

1/8" thick low-pressure laminated hardboard surfaced white on front side. This substrate is intended for interior use only.

Additional backers are:

Fluted plastic - (Coroplast). Interior and exterior use.

Polystyrene - white two sided. Interior and exterior use.

Dry Erase laminate on 1/8" hardboard substrate one side.

Interior use.

Acrylic - for illumination

Frame Profile Sizes

Face profile - Width: 1-3/4" (45 mm) Depth: 5/16"

Wall Thickness: .050" Open Back Profile - Width 9/32"

Open Back Profile - Width 1 9/16"

Frame Maximum Size:

Any size can be custom made up to 94" x 94" poster size. (46"x 94" w/backer)

Larger sizes are capable by joining top and back profile in "seamed" sections allowing for your larger graphics projects.

Standard sizes:

All frame dimensions are "graphic size". For frames outside dimensions add 2" to height and width.

LED LIGHT PANEL

ILLUMINATED SEKÜREFRAME™

Our innovative, edge-lit, LED panels evenly light your promotional graphics, giving them a stunning glow. Unlike most light boxes, which put a lamp on the backside, our light panel is produced by combining high brightness LED with an exclusive 3D V-Cut crystal acrylic lens.

Available in Anodized Aluminum and Black Finishes. Custom colors are also available, Minimums may apply.

- Available in four of your most popular graphic sizes.
- Snap-open, snap-closed rails make it simple to change graphics.
- Extremely thin profile provides an elegant look.
- Low voltage (12V) power source connected to a remotely located transformer.
- 4 mm thick LED panel and 8 mm panel for larger applications.
- Eco Friendly: No mercury or other heavy metals.
- Cost efficient: Consumes up to 70% less power than T4 fluorescent lamp and 30% less energy than Cold Cathode Fluorescent lamp.
- 4 standard sizes. Other custom sizes available, minimums may apply.
- Moisture resistant and maintenance free.
- 2 year guarantee on Light Panel. Life expectancy of LED panel is 50,000 hours. Based on 12 hour days, life expectancy is 11.56 years.
- Walls+Forms LED panel combines LED in itself as a light source. Unlike most light boxes, which put a lamp in the outside, the light panel is produced by combining high brightness LED imbedded into a 3D V-cut exclusive crystal acrylic lens.
- Universal power adapter for US or international use. 100v - 240v 50/60 hertz. Please specify plug style needed when ordering.

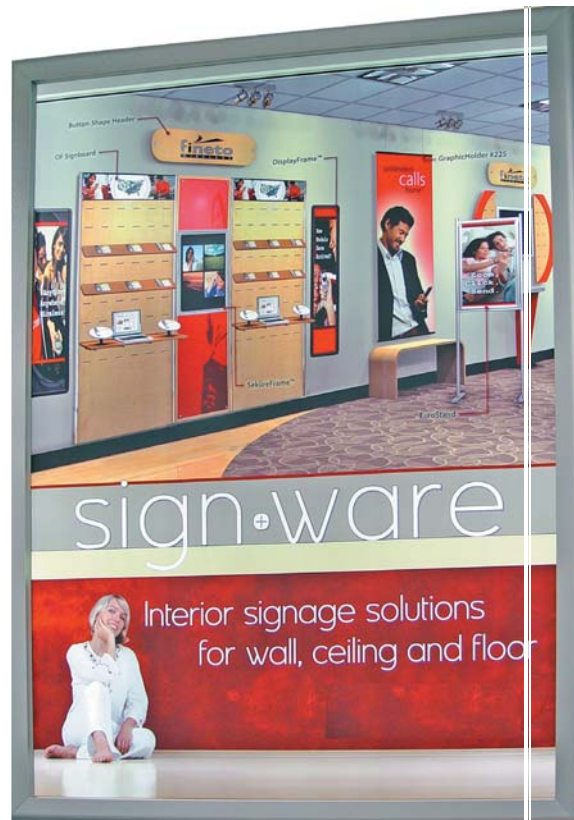

High Brightness LED with V-Cut Acrylic Lens for Enhanced Brightness and Even Light Distribution

Easy-Open Front-Loading Frames allow for Quick Changing of Graphics

| ITEM# | GRAPHIC SIZE |
|---------|--------------|
| B3-1803 | 18"w X 24"h |
| C1-1805 | 22"w X 28"h |
| B2-1202 | 24"w x 36"h |
| B0-1800 | 36"w x 48"h |

DISPLAYFRAME™

A USER FRIENDLY FRONT-LOADING FRAME

An effective “front-loading” poster frame, DisplayFrame™ is designed to be attached to walls, media displays, windows and more. Standard DisplayFrames™ are constructed of durable plastic or aluminum frame profiles and feature integrated radius corners with durable backer boards. The contoured frame profiles are factory applied onto our “Flex Hinges” which are mechanically mounted to your choice of tempered hardboard, fluted coroplast board, polystyrene or dry erase backer board. Each DisplayFrame™ includes “ready to use” mounting holes, double side corner tape and screws.

DisplayFrames™ feature our patented “Flex-Hinge”. This unique hinge allows the entire frame and corner to open easily for quick sign installation.

To protect your graphic panel from moisture and dirt, clear “anti-reflective” protective lenses are also available.

All DisplayFrames™ will hold a substrate thickness up to 3/32”.

Due the diversity of applications, we suggest that you pre-test graphic thickness, prior to purchasing. Samples are available upon request.

* Aztec Gold is a Custom Color. Custom Colors are not stocked items. Please note that special pricing & minimums will apply.

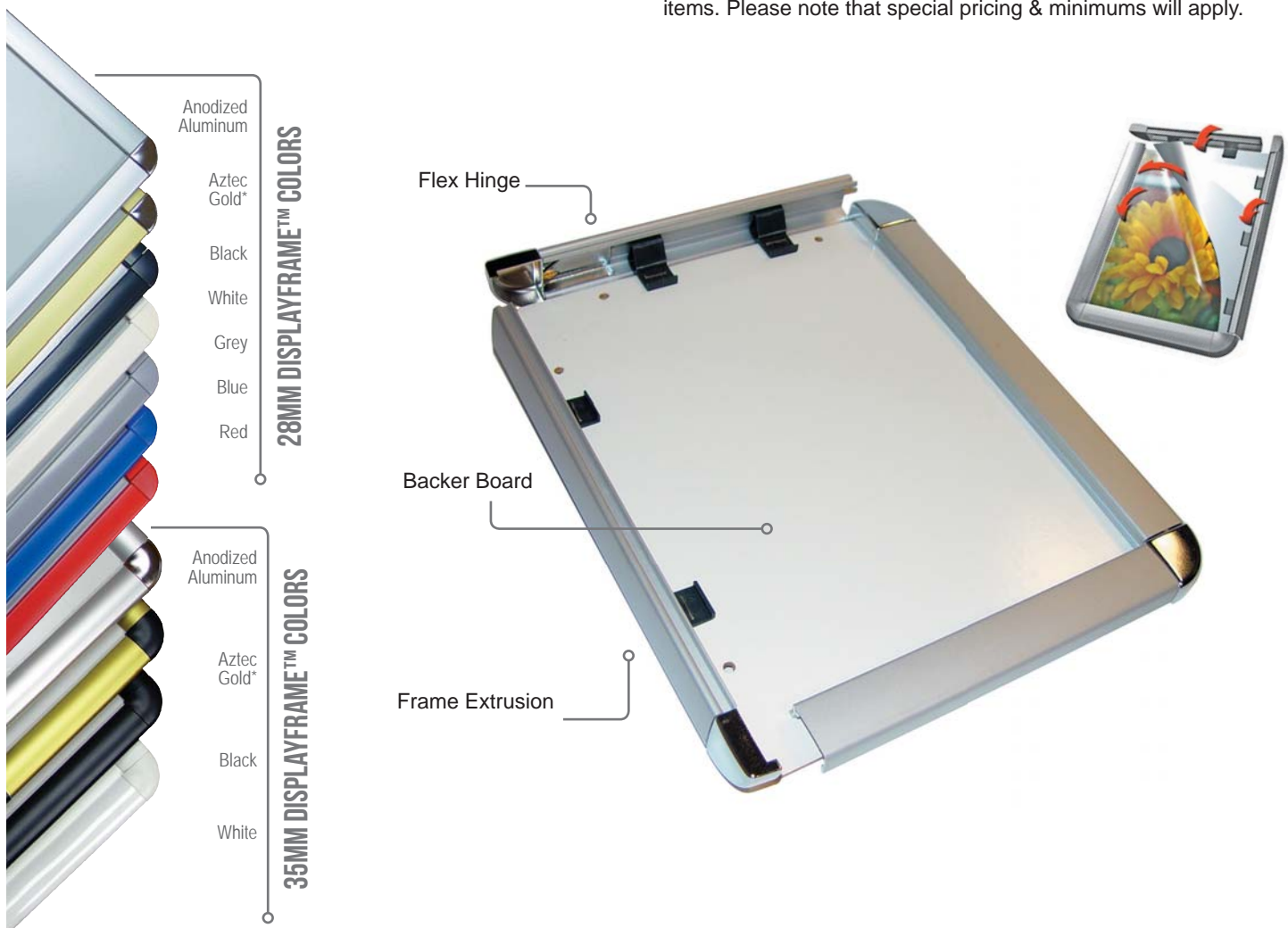

SPECIFICATIONS

Colors / Finishes:

Standard frame UV resistant plastic:

White, gray, black, red and blue.

Aluminum Clear Anodized Satin

Corners:

Radius plastic corners:

White, gray, black, red and blue and "chrome" is available for satin aluminum frames.

Mitered corners are also available.

Backer Board Options:

The standard backer:

1/8" thick low-pressure laminated hardboard surfaced white on front side. This substrate is intended for interior use only.

Additional backers are:

Fluted plastic - (Coroplast). Interior and exterior use.

Polystyrene - white two sided. Interior and exterior use.

Dry Erase laminate on 1/8" hardboard substrate one side.

Interior use.

Frame Profile Sizes

28 mm or 35mm width.

Frame Maximum Size:

Any size can be custom made up to 46" x 94" poster size. (46"x 94" w/ backer)

Standard sizes:

All frame dimensions are "graphic size". For frames outside dimensions add 1-5/16" to height and width.

| ITEM# | GRAPHIC SIZE |
|---------|--------------|
| B0-1400 | 36"w x 48"h |
| B1-1401 | 30"w x 40"h |
| B2-1402 | 24"w x 36"h |
| C1-1405 | 22"w x 28"h |
| C2-1406 | 24"w x 24"h |
| C3-1407 | 20"w x 20"h |
| B3-1403 | 18"w x 24"h |
| B5-1409 | 8½"w x 11"h |

For the "do it yourself", all components are available in stock sizes and color finishes.

Refer to 'page 26' for components ordering.



SEKÜREFRAME™

A USER FRIENDLY FRONT-LOADING FRAME

The industry standard "Spring Hinges" are precisely sized to insure a quality opening and closing for years of use. The unique frame design allows hinges to be removed or added to create the tension that is appropriated for your application. By increasing the tension, SeküreFrame™ is the perfect choice for tamper resistance in areas such as hallways, rest rooms, airports and more.

This unique frame offers you the choice of open back feature (for wall mount) or "with backer". The optional back feature allows you the option to present a permanent message when your poster is not in place. Additionally the backer can be used to allow for custom shaped Die-Cut portions of the back panel to extend past the top/side of the frame.

SeküreFrame™ is a "user-friendly" front-loading graphic frame system manufactured for the signage professional. Designed for interior and exterior graphic applications. The slim all aluminum profile can enhance any signage installation. Inspired by classic "Art Deco" style, SeküreFrames™ stylized lines flow into each precision mitered corner creating a look that is uniquely new and innovative.



Spring Hinge

Corner Brackets

Frame Base

Frame Top

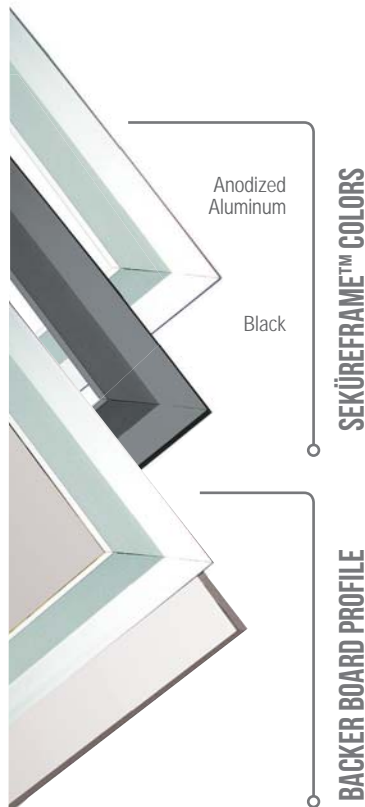

DIE-CUT GRAPHICS



The Backer Board Profile allows you to place semipermanent "die-cut" graphics behind the frame while leaving the front open to promotions.

SPECIFICATIONS

Colors / Finishes:

Clear Satin Anodized and Black Anodized finish 3 mil.

Note: Other colors are available; minimums may apply.

Corners:

Factory mitered for precise clean edges.

Backer Board Options:

The standard backer:

1/8" thick low-pressure laminated hardboard surfaced white on front side. This substrate is intended for interior use only.

Additional backers are:

Fluted plastic - (Coroplast). Interior and exterior use.

Polystyrene - white two sided. Interior and exterior use.

Dry Erase laminate on 1/8" hardboard substrate one side.

Interior use.

Frame Profile Sizes

31.75 mm width.

Face profile - Width: 1 1/4", Depth: 5/16",

Wall Thickness: .050"

Open Back Profile - Width 1 9/16"

Frame Maximum Size:

Any size can be custom made up to 94" x 94" poster size. (46"x 94" w/backer)

Larger sizes are capable by joining top and back profile in "seamed" sections allowing for your larger graphics projects.

Standard sizes:

All frame dimensions are "graphic size". For frames outside dimensions add 2" to height and width.

| ITEM# | GRAPHIC SIZE |
|---------|--------------|
| B0-1600 | 36"w x 48"h |
| B1-1601 | 30"w x 40"h |
| B2-1602 | 24"w x 36"h |
| C1-1605 | 22"w x 28"h |
| C2-1606 | 24"w x 24"h |
| C3-1607 | 20"w x 20"h |
| B3-1603 | 18"w x 24"h |
| B4-1604 | 11"w x 14"h |
| B5-1609 | 8½"w x 11"h |

For the "do it yourself", all components are available in stock sizes and color finishes.

Refer to 'page 26' for components ordering.



GRAPHIC HOLDERS

FOR OEM AND DIY CUSTOMERS

Graphic Holders are the perfect solution for hanging wall mounted or suspended signage in windows or on walls. Three styles of Graphic Holders offer economical, or stylized options for mounting your flexible graphics. All three Graphic Holders feature a “Hanger Hook” tab slot on back and a “Grip Strip” two part co-extrusion that will hold sign material securely.

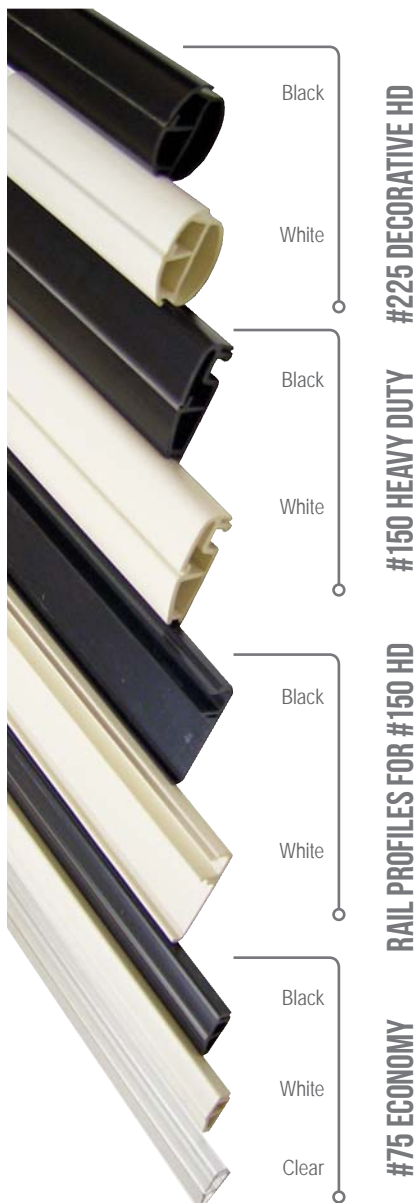

Graphic Holders offer uniform tension and presentation for all types of flexible materials. Designed for quick changing of graphics and years of use.



SPECIFICATIONS

Graphic Holder #75 - "Economy"

Holds material up to .04" thickness. Designed for Wall and Ceiling (Suspended) Mounting. Graphic Holder comes in ¾" nominal height x 96" lengths. Please specify the length desired.

Graphic Holder #150 - "Heavy Duty"

Holds material up to .08 thickness. Designed for Wall and Ceiling (Suspended) Mounting. Graphic Holder comes in 1.5" nominal height x 96" lengths. Please specify the length desired.

Rail Profile for #150

Specifically designed for the #150 Graphic Holder, the rail holder track a simple way to wall mount graphics and allow the #150 to "snap" into place. Simplifies installation, changing of graphics and mounting. Rail profile comes in 1.5" nominal height x 96" lengths. Please specify the length desired.

Graphic Holder #225 - "Decorative"

Holds material up to .08 thickness. Designed for Ceiling (Suspended) Mounting. Graphic Holder comes in 1.25" nominal height x 48" lengths. Please specify length desired.

Please specify the length desired when ordering. There are No Cutting Charges for Graphic Holders. Pricing will be based on 96" lengths #75 & #150 or 48" lengths for #225. When buying cut sizes "Drop" pieces will be included in price.

| ITEM# | SIZE |
|----------|-------------------|
| 1100-75 | #75 Holder (96") |
| 1100-150 | #150 Holder (96") |
| 1102-L/R | #150 EndCap |
| 1103 | #150 Rail Profile |
| 225 | #225 Holder (48") |
| 226 | #225 Endcap |
| 1101 | Hanger Hooks* |

*Works with #75, #150 and #225

Hanger Hooks

Easy to use hanger hooks snap into slot of Graphic Holders for suspended or wall mounting. The number of hangers needed depends on the specific application. We recommend a minimum of one hanger hook for each 24" of Graphic Holder length. The #150 and #225 holders are designed for wider graphics and therefore require fewer hooks.

End Caps #150

Designed specifically for the #150 to cap off the ends of the extrusion.

End Caps #225

Because of the #225's unique front and back decorative design it requires a unique end cap.



2-WAY FRAME

2-SIDED SUSPENDED DISPLAY

Wall+Forms 2-WayFrame is the latest member of the EuroSign™ Family of signage products. We start with our 'user-friendly' front-loading SeküreFrame™ manufactured for the signage professional. We combine two frames in a "back-to-back" configuration with hanging tabs for suspended applications.

Each side of the 2-WayFrame easily opens to accept signage. The industry standard "Spring hinges" are precisely sized to insure a quality opening and closing for years of use. The optional back feature allows you the option to present a permanent message when your poster is not in place. To protect your graphic panel from moisture and dirt, clear "anti-reflective" lenses are also available.

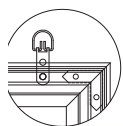

Pre-attached hanging tabs

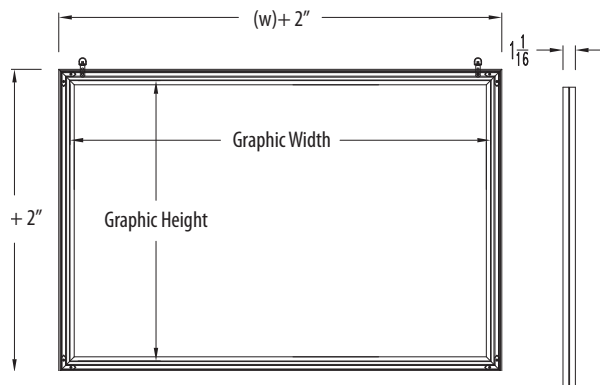

SPECIFICATIONS

Colors/ Finishes:

Standard frame finishes are - Clear Satin Anodized and Black Anodized finish 3 mil. Note: other colors are available; minimums may apply.

Backer Board Options:

The standard backer is 1/8" thick low-pressure laminated hardboard surfaced white on front side. This substrate is intended for interior use only.

Additional backer panels:

Fluted plastic - (Coroplast). Interior and exterior use.

Polystyrene - white two sided. Interior and exterior use.

Frame Sizes:

All frame dimensions are "graphic size". For frames outside dimensions add 2" to height and 2" to width. Height and width must be specified when ordering to mount hanging tabs in proper location for portrait or landscape applications. Any size can be custom made up to 46" x 94" poster size.

Note: Custom sizes available upon request.

Please contact customer service for prices and product details.

| ITEM# | GRAPHIC SIZE |
|--------------|--------------|
| BO-1600-2Way | 36"w x 48"h |
| B1-1601-2Way | 30"w x 40"h |
| B2-1602-2Way | 24"w x 36"h |
| C1-1605-2Way | 22"w x 28"h |
| C2-1606-2Way | 24"w x 24"h |
| C3-1607-2Way | 20"w x 20"h |
| B3-1603-2Way | 18"w x 24"h |
| B4-1604-2Way | 11"w x 14"h |
| B5-1609-2Way | 8½"w x 11"h |

For the "do it yourself", all components are available in stock sizes and colors finishes. Refer to 'page 26' for components ordering.

4-WAY FRAME

4-SIDED SUSPENDED DISPLAY

Create 4-sided suspended displays without breaking your budget. 4-WayFrame assembles in minutes, saving you both headaches and money on installation. With just two simple screws at each corner, the 4-WayFrame can be assembled quickly and easily; no special tools or installation crew are necessary.

Frames are front-loading for easy graphic changing. Never needs to be disassembled to change graphics. Simply snap open the SeküreFrame™ to change graphics in and out instantly.

Display ships broken down for easy shipping. Optional backer panels and “anti-reflective” protective lenses also available.



L-Channel & Hanger Tabs

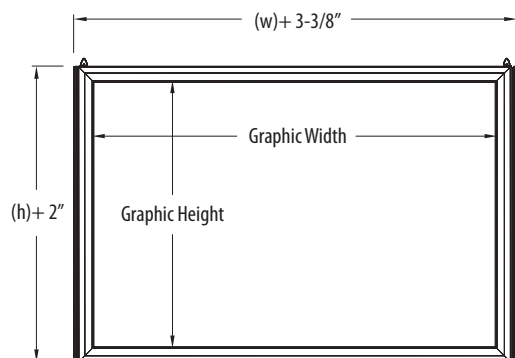

SPECIFICATIONS

Colors/ Finishes:

Standard frame finishes are - Clear Satin Anodized and Black Anodized finish 3 mil. Note: other colors are available; minimums may apply.

Backer Board Options:

The standard backer is 1/8" thick low-pressure laminated hardboard surfaced white on front side. This substrate is intended for interior use only.

Additional backer panels:

Fluted plastic - (Coroplast). Interior and exterior use.

Polystyrene - white two sided. Interior and exterior use.

Frame Sizes:

All frame dimensions are “graphic size”. For frames outside dimensions add 2" to height and 2" to width. Height and width must be specified when ordering to mount hanging tabs in proper location for portrait or landscape applications. Any size can be custom made up to 46" x 94" poster size.

Note: Custom sizes available upon request.

Please contact customer service for prices and product details.

| ITEM# | GRAPHIC SIZE |
|----------------|--------------|
| BO-1600 – 4Way | 36"w x 48"h |
| B1-1601 – 4Way | 30"w x 40"h |
| B2-1602 – 4Way | 24"w x 36"h |
| C1-1605 – 4Way | 22"w x 28"h |
| C2-1606 – 4Way | 24"w x 24"h |
| C3-1607 – 4Way | 20"w x 20"h |
| B3-1603 – 4Way | 18"w x 24"h |
| B4-1604 – 4Way | 11"w x 14"h |
| B5-1609 – 4Way | 8½"w x 11"h |

For the “do it yourself”, all components are available in stock sizes and colors finishes. Refer to ‘page 26’ for components ordering.

BE FIT



SALE
CLEARANCE

25%
OFF
sale sale sale

SIGN STANDS



GRAPHIC STAND
EURO STAND
WINDFRAME
SANDWICHBOARD
BULLETIN HOLDERS
BANNER STAND



WALLS+
FORMS

GRAPHIC STAND

NORTH AMERICAN STYLE GRAPHIC STAND

SPECIFICATIONS

Dimensions:

46.5" (H) x 26" or 24" (W) x 28" (D); Standard unit is double sided with frames on both sides. Single sided stands are available.

GS1300 – unit includes two frames - 24"(W) x 36"(H)

GS1301 – unit includes two frames - 22"(W) x 28"(H)

Colors/ Finishes:

Specify DisplayFrame™ or SeküreFrame™ "front-loading" frames when ordering. Reference colors available in frames product section. Legs are available in Satin Clear Anodized finish with black end caps and top hinge.

Backer Board Options:

The standard backer is 1/8" thick low pressure laminated hardboard surfaced white on front side. This substrate is intended for interior use only.

Additional backer panels:

Fluted plastic - (Coroplast). Interior and exterior use.

Polystyrene - white two sided. Interior and exterior use.

Dry Erase Laminate on 1/8" hardboard substrate one side. Interior use.

Frame (graphic) Sizes:

Standard poster sizes are:

24"(W) x 36"(H) or 22"(W) x 28"(H)

Note: Custom sizes available upon request.

Please contact customer service for prices and product details.

| ITEM# | GRAPHIC SIZE |
|--------|--------------|
| GS1300 | 24"w x 36"h |
| GS1301 | 22"w x 28"h |

Wall+Forms' Graphic Stand is a new look to a proven advertising vehicle. The contemporary design and durable construction allows your message to be easily seen. Designed for a wide variety of commercial uses; retail, restaurants, hotel lobbies, hospital, trade show and more. Indoors or outdoors these "advertising stands" can attract customer as they pass by, or inform as they enter. Now you can select the optimum location to promote your company, product or exclusive offer.

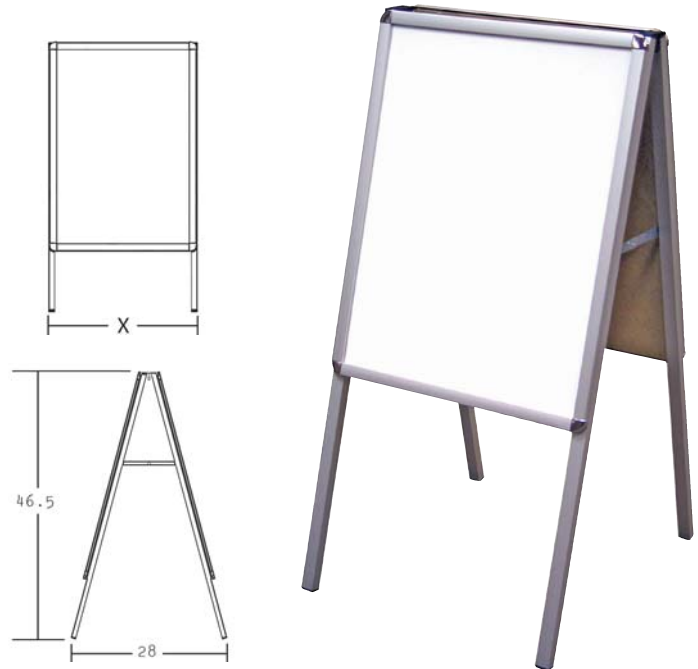

Graphic Stands are made to order, specify the height and width of the stand as well as the type of sign frame; DisplayFrame™ or SeküreFrame™. The choice is yours.

Each Graphic Stand consists of two pair of pre-finished aluminum legs that are joined by our patented W+F Top Hinge. This unique hinge features a "sign holder slot" that automatically opens when Graphic Stand's legs are open to receive a graphic header. No need for additional hardware. It's an easy and quick way to create a greater impact.

Graphic Stands comes with durable and scratch resistant end cap "feet" that are safe for any floor and leg braces that allow the stand to easily erect and safely lock into place.

For the "do it yourself", all Graphic Stand components are available in stock sizes, colors or finishes. All components are available in stock sizes and colors finishes. Refer to 'page 26' for components ordering.

EURO STAND

EUROPEAN STYLE GRAPHIC STAND

SPECIFICATIONS

Dimensions:

60" (H) x 30" or 28" (W) x 18" (D); Additional custom sizes are available. Standard unit is double sided with frames on both sides. Single sided stands are also available upon request.

ES1350-1 – pre-assembled unit includes two frames 24"(W) x 36"(H) (DisplayFrames™ or SeküreFrames™)

ES1350-2 – pre-assembled unit includes two frames - 22"(W) x 28"(H) (DisplayFrames™ or SeküreFrames™)

Colors/ Finishes:

Specify DisplayFrame™ or Seküre Frame™ "front-loading" frames when ordering. Reference colors available in frames product section. Octagon "vertical/horizontal" posts: Clear Anodized Satin or Black Anodized Finish w/ black end caps.

Backer Board Options:

The standard backer is 1/8" thick lowpressure laminated hardboard surfaced white on front side. This substrate is intended for interior use only.

Additional backer panels:

Fluted plastic - (Coroplast). Interior and exterior use.

Polystyrene - white two sided. Interior and exterior use.

Dry Erase Laminate on 1/8" hardboard substrate one side. Interior use.

Frame (graphic) Sizes:

Standard poster sizes are:

24"(W) x 36"(H) or 22"(W) x 28"(H)

| ITEM# | GRAPHIC SIZE |
|----------|--------------|
| ES1350-1 | 24"w x 36"h |
| ES1350-2 | 22"w x 28"h |



EuroStands™. These multi-functional merchandisers do the job of high-impact visual merchandising and point-of-purchase. EuroSign™ EuroStands are ideal for applications including commercial graphics, point-of-purchase, convention centers, exhibit halls, retail stores, banks, brokerage firms, insurance and mortgage companies, travel agencies, movie theatres, live productions, casinos, hotels, resorts, restaurants, schools, general commercial use and more. EuroSign™ EuroStands are simple to use, easy to install, and ready for personalization. They combine style with function and feature a user-friendly "front loading" frame design.

EuroSign™ EuroStands are ideally suited for full color lifestyle posters, promotional ads, or any other visual merchandising application. Materials fit securely in this frame and graphics can be changed in seconds. The components are made from industrial grade materials.

Signs, posters, and graphics can be inserted from the front, thus eliminating the possibility of unnecessary wear and tear. EuroStands are available in Clear Anodized Satin or Black Anodized finish along with a wide variety of eye-catching designer frame colors in aluminum or plastic. Frames and corner colors can be mixed and matched to enhance the look of any décor.

WIND FRAME

OUTDOOR HIGH ENDURANCE PLATFORM

Designed for exterior use in windy environments the WindFrame is the perfect choice for your convenience store, valet station, gas station, or any outdoor application. WindFrame features front opening "Snap frame" technology that allows for easy changing of graphics as needed. The "spring" base allows for flexing of the sign to prevent high winds from knocking over your display. The frame is a double-sided heavy-duty aluminum frame with aluminum sign backer panel. Designed to hold standard posters (not included) from 28" x 44" to 26.5 x 42.5". The base is constructed of steel feet with spring base. Feet have rubber non-skid stoppers. Some assembly is required. Unit is UPS/ FedEx shippable.



SPECIFICATIONS

Dimensions:

54.5" (H) x 29" (W) x 53" (D)

Standard unit is double sided with frames on both sides. are available.

Weight:

Unit weights 35lbs

Colors/ Finishes:

Available only in black frames with white metal backer panel.

Frame (graphic) Sizes:

Standard poster sizes is 28"(W) x 44"(H) but will hold minimum 26.5" x 42.5".

Visible opening is 25.75" x 41.75"

Standard Sizes:

28" x 44" Graphic Size

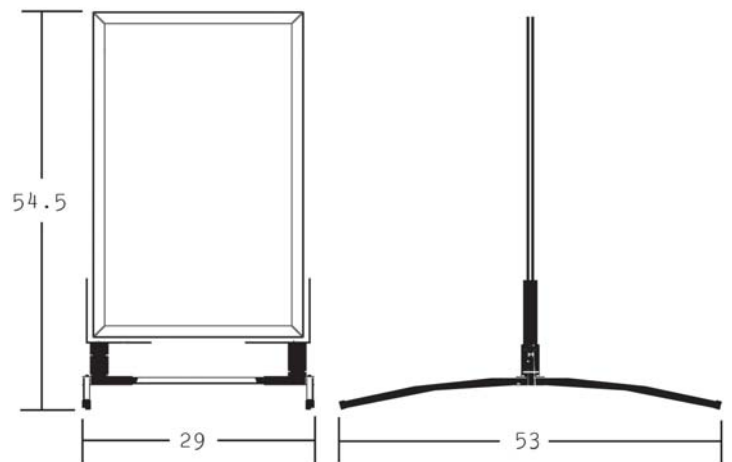

| ITEM# | GRAPHIC SIZE |
|--------|--------------|
| WF2844 | 28"w x 44"h |

SANDWICHBOARD

INDOOR/OUTDOOR ALL-PURPOSE SIGN

Walls+Forms™ Graphic Sandwich Boards bring advertising to a new era with a cost effective solution for displaying interchangeable graphics. The sandwich board is designed for standard 24" x 36" posters. The molded plastic display is made to withstand the harshest exterior conditions. The lightweight, high strength polyethylene display is made to perform year after year. Each unit includes easy to use mounting hardware consisting of Velcro tabs and button locks.

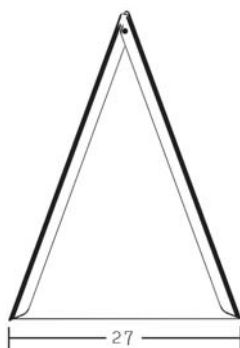
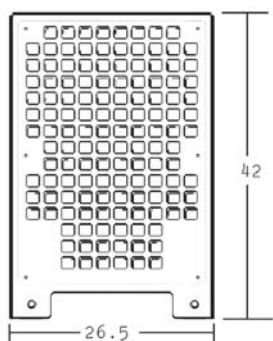

SPECIFICATIONS

Dimensions:

Overall - 26-1/2" (W) x 42" (H) Graphic size - 24" (W) x 36" (H)

Colors/ Finishes:

Black (only)

Unit Consists of:

2- Commercial grade molded polyethylene graphic boards hinged together.

2- Tie Straps

1- Bag; containing an assortment of Velcro tabs and push tabs buttons for graphic placement

Note- buttons are for semi-permanent application of graphics.

Alternative push tabs are available on a custom basis for customers wanting to allow for easier changing of graphics. Contact customer service for optional removable tabs.

Backer:

Unit does not come with backer panel for decorating. Standard backer available in white fluted plastic (Coroplast). Backer panel has holes pre-drilled for push button tabs to mount to sandwich board. Suggested backers are 1/8" hardboard, .040 to .080 polystyrene, 60lb poster stock or coroplast.

Weight:

12 lbs (ships as 30 lbs. Dimensional weight -UPS)

Clear Lens:

.010 Clear Lexan Protector lenses are available to protect front of graphic.

Note- Clear lens does not provide complete protection for outdoor use.

Moisture can still "wick" from sides. We recommend graphics be printed in UV resistant inks on weather resistant material.

| ITEM# | GRAPHIC SIZE |
|-------|--------------|
| SB-BK | 24"w x 36"h |

BULLETIN HOLDERS

INDOOR ALL-PURPOSE SIGN

Bulletin Holders are an economical way to display your promotional graphics. Available in two styles, the holders allow for top loading of graphics mounted on foam board, gator-foam, pvc, polystyrene or alternative rigid backers up to 1/4" thick. The Bulletin sign holders are designed to present messages on two sides. Features steel construction and come ready to assemble with simple instructions. Both stands come in powder coated black or chrome.

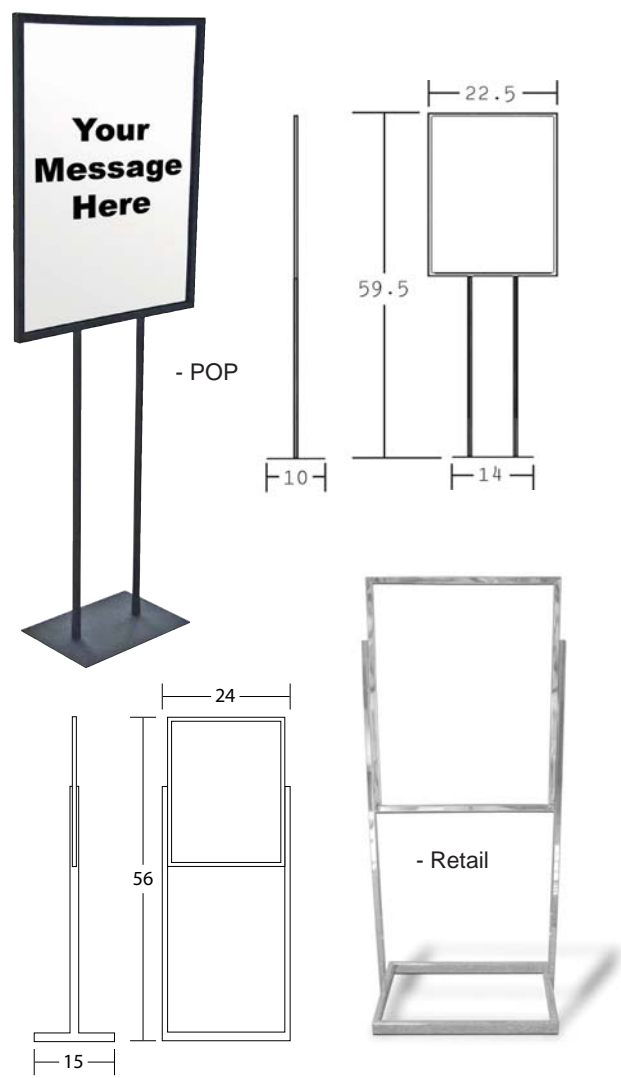

SPECIFICATIONS

POP Bulletin Holder

Dimensions:

22.5"(W) x 59.5"(H), Base is 10"(deep) x 14" (wide) Flat steel base. Risers are constructed from 1" tubes. Features steel construction and come ready to assemble with simple instructions

Frame graphic size:

Holds standard size 22"(W) x 28"(H) poster size up to 1/4" thick

Retail Bulletin Holder

Dimensions:

24" (W) x 56 (H), Base is 15"(D) x 24"(W) Constructed from 5/8" x 1-5/8" rectangular tube for sides and base. Features steel construction and come ready to assemble with simple instructions

Frame graphic size:

Holds standard size 22"(W) x 28"(H) poster size up to 1/4" thickness.

Colors/ Finishes: (Both Models)

Black or Chrome

| ITEM# | GRAPHIC SIZE |
|-------|--------------|
| PP-BH | 22"w x 28"h |
| RT-BH | 22"w x 28"h |

BANNER STAND

INDOOR PROMOTION PLATFORM

Adjustable height free standing banner display. Sturdy steel construction, stand features an adjustable banner height from 43" to 96". Stand has a 16" square base. Accepts 24" wide hemmed banners on one or both sides. Comes with four (x4) 24" round dowels for mounting banners. No need to notch banners.

Banner Stand also offers optional Graphic Holders. #75 Graphic Holders feature "Grip Strip" technology that holds material securely. These holders conveniently slide into Banner Stand dowel tracks for quick and easy changing of graphics. Eliminates the need to hem banners/prints

SPECIFICATIONS

Dimensions:

56" (H) x 16" (W) x 16" (D) (height at lowest point) 43" banner height 107" (H) x 16" x 16" (height at highest setting) 95" banner height max

Weight:

Unit weights 20 lbs.

Colors/ Finishes:

Black

| ITEM# | GRAPHIC SIZE |
|-------|----------------|
| BANS | 24"w x 43-96"h |

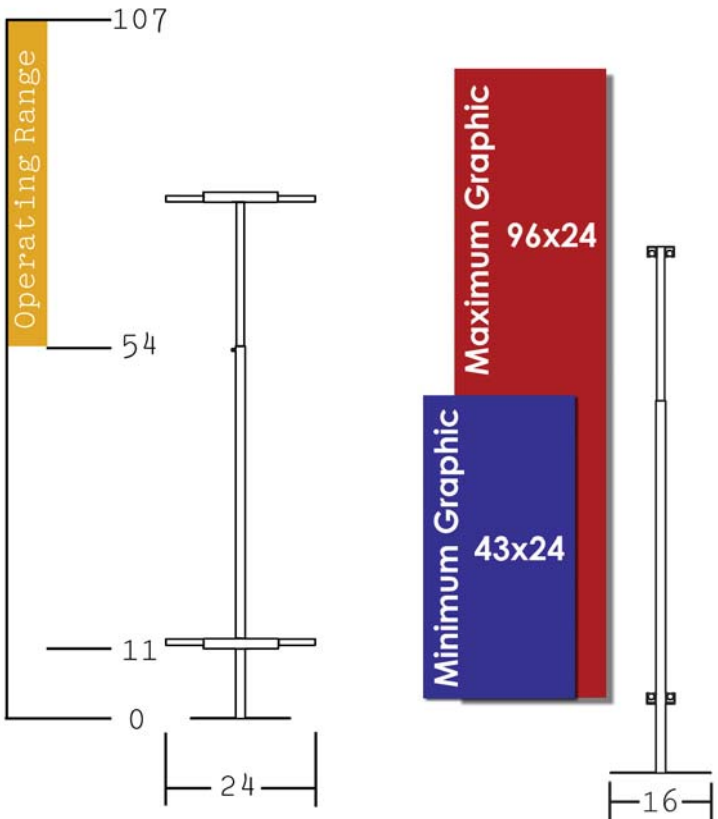



ESTÉE LAUDER

LANCÔME

COSMETICS

ESTÉE LAUDER
EXPERT
FOUNDATION
FITTING

ESTÉE LAUDER

ESTÉE LAUDER

ESTÉE LAUDER

LANCÔME

LANCÔME

LANCÔME

SIGN WARE



PROFILE HEADER
HEADER SIGNS
COMPONENTS



WALLS+
FORMS_{LLC}

PROFILE HEADERS

INDOOR/OUTDOOR SHAPED PLATFORM

Durable plastic constructed signboards feature top and bottom track; open face design allows quick and easy insertion of graphic card material to channel. Adapter track feature located at back of signboard runs entire width and can receive multiple slatwall and/ or grid adapter clips as required.



Open-Face signboards feature top and bottom track; design allows quick and easy insertion of graphic card material to face.

Signboard - 12" OF (JA-2213R) (Holds 12" tall material)

Color: Black

Dimensions: 12" (H) x 48" (W)

Signboard – 8"- OF (JA-2169) (Holds 8" tall material)

Color: Black

Dimensions: 8" (H) x 56" (W)



Clear "Covered Face" design features a "Front Cover" to protect graphic from wear and tampering. Rear mounting track runs entire width and accepts slatwall and grid adapter clips.

Signboard – 7"-CF (JA-E584)

(Holds 7" tall material)

Color: Clear

Dimensions: 7" (H) x 52" (W)



Slatwall Adapter Clip (JA-E122)

Color: Clear

Dimensions: 1.5" (D) x 2.5" (W)

Adapter clip attaches to 12", 8" and 7" signboards by simply sliding clips onto signboard adapter track. Slatwall adapter is designed to attach to standard slatwall and slat grid opening.



Grid Adapter Clip (JA-E169)

Color: Clear

Dimensions: 1.5" depth x 2.5" width

Adapter grid clip attaches to 12", 8" and 7" signboards. Clip is designed to "snap onto standard 1/4" diameter wire.

HEADER SIGNS

INDOOR PROMOTION PLATFORM

Header Signs are available in non-illuminated and illuminated versions. Both versions are designed primarily for perimeter wall applications and are easy to install, change and reposition as the need arises. Header Signs provide customers ‘direction’ to product categories, product groupings and, by displaying a logo, reinforces product branding. For quick and easy graphic installation, headers are available with ‘front loading’ aluminum or colorful plastic frames.

Walls+Forms’ Header Signs are the perfect graphic tool for speciality dealer shop, temporary retail installation and seasonal vignettes.

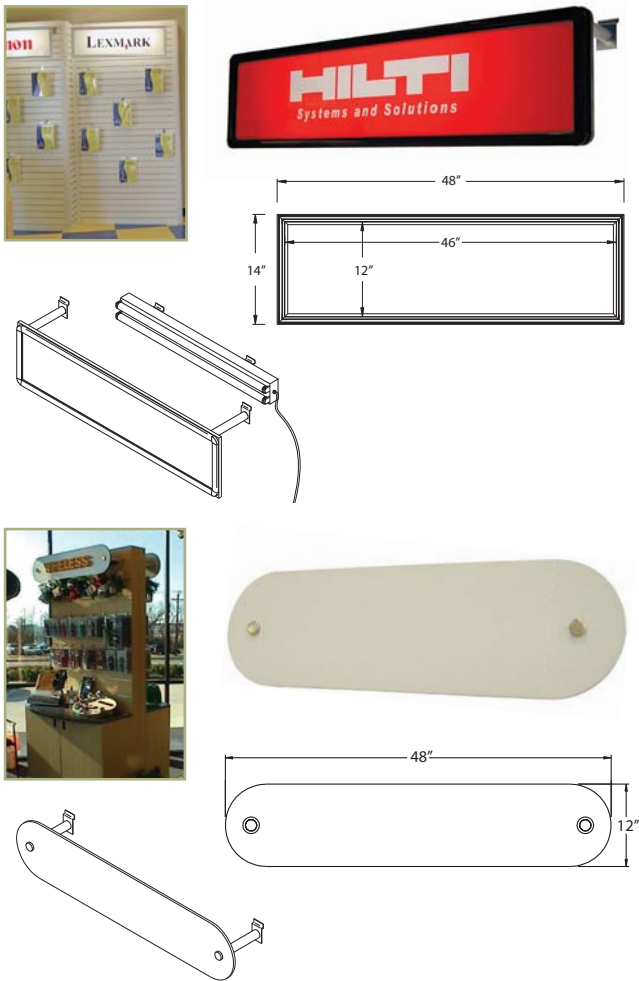

SPECIFICATIONS

Frame HeaderSigns*

Illuminated & Non-Illuminated

Both headers feature Walls+Forms™ ‘Front-Loading’ Frame Technology (DisplayFrame™ or SeküreFrame™).

Illuminated headers are manufactured with a translucent acrylic backer to provide uniform lighting form the light fixture.

Non-Illuminated headers are manufactured with a solid backer. ‘Stand-off’ mounting arms are standard in 11-1/2” length and features a slatwall or gridwall mounting bracket.

Dimensions:

14” (Height) x 48” (Width) x 12” (Depth)
12” (Height) x 46” (Width) Poster Size
Color: SeküreFrame™ - black or satin aluminum finish
DisplayFrame™ - white, black, blue, red, almond or satin-aluminum finish.

Button-Shaped - HeaderSigns*

Non-illuminated oval sign is designed to receive dimensional letters or vinyl adhesive letters or your full color graphics. An infinite number of color selections and custom shapes are available.

Dimensions:

12” or 8” (Height) x 48” (Width)
Color: various

| ITEM# | NAME | SIZE |
|---|-------------------|---------|
| JA-2169-BK | Open-Face | 8” x48” |
| JA-2213R-BK | Open-Face | 12”x48” |
| JA-E584-CL | Covered Face | 7” x52” |
| WD-0148 | Frame HeaderSign* | 12”x48” |
| B1-WD-0145 | Button-Shape** | 8” x48” |
| WDO-145 | Button-Shape** | 12”x48” |
| * Minimum quantity of 5 units per order | | |
| ** Minimum quantity of 25 units per order | | |

COMPONENTS

FOR OEM AND DIY CUSTOMERS

DisplayFrame™



Profile (35mm) - #4925-35
Used to construct 35mm Frames.
Colors: Blk, Wht, Alu
Length: 96"

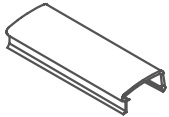

Profile (28mm) - #4925-28
Used to construct 28mm Frames.
Colors: Blk, Wht, Blu, Red, Alu, Gray
Length: 96"

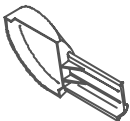

Corner (35mm) - #5526-35
Used to construct 35mm Frames.
Colors: Blk, Wht, Blu, Red, Chr

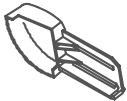

Corner (28mm) - #5526-28
Used to construct 28mm Frames.
Colors: Blk, Wht, Blu, Red, Alu, Gray



Staple Hinge - #LA-7303-FH
Staple mount hinge used to construct 28mm/35mm Frames.
Colors: Blk



Hole Hinge - #LA-7303-FHH
Rivet or screw mount hinge used to construct 28mm/35mm Frames.
Colors: Blk

EuroStand™

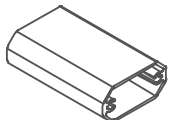

Post - #ES5020
Used to construct EuroStands
Colors: Blk, Alu
Length: 96"

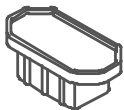

Post Cap - #CP1144
Caps off open post ends
Colors: Blk



Fastening Screw - #ES-Screw
Used to construct EuroStands
Colors: Stainless Steel



Fastening Screw - #ES-Screw
Caps off fastening screw holes in post
Colors: Metal Finish

SeküreFrame™

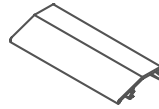

Frame Top - #1620-FF-1.25
Used to construct Standard frames.
Colors: Blk, Alu
Length: 96"

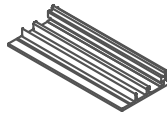

Frame Base - #1625-BF-1.28
Used to construct standard frames.
Colors: Blk, Alu
Length: 96"

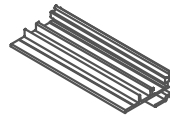

Frame Base+Backer - #1626-PBF-1.28
Used to construct standard frames able to accept back panels.
Colors: Blk, Alu
Length: 96"



Corner Bracket - #1630-00
Used to construct standard frames.
Colors: Stainless Steel



Spring Clip - #1632-01
Used to add frame tension.
Colors: Stainless Steel

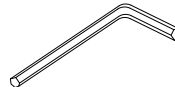

Allen Wrench
Tool needed to construct standard frames.
Colors: N/A

GraphicStand™

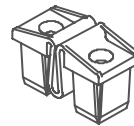

Frame Hinge with Tight Fastener - #1201
Used to construct GraphicStands.
Colors: Blk
Length: N/A

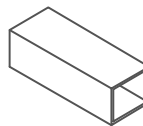

Leg Post - #1200
Used to construct GraphicStands.
Colors: Alu
Length: 96"



End Cap Foot - #1202
Used to construct GraphicStands.
Colors: Blk
Length: N/A

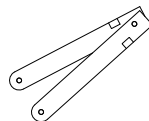

Folding Brace - #1203
Used to construct GraphicStands.
Colors: Stainless Steel
Length: 10"

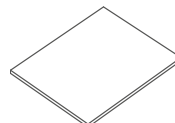

LPL Backer Panel - #1600
Used to construct GraphicStands.
Colors: White
Size: 48"x 96"

COMPONENTS

FOR OEM AND DIY CUSTOMERS

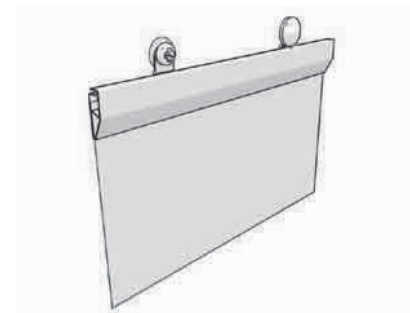
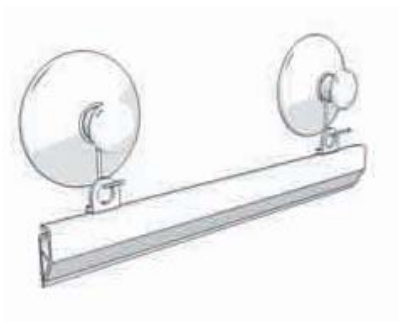
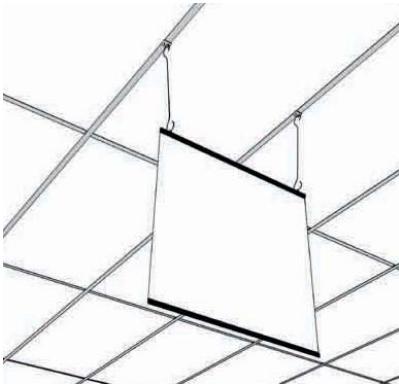

| ITEM# | NAME | SIZE |
|-------|-------------------------|---------|
| 1130 | Ceiling Grid Clip | 1" |
| 1131 | Ceiling Grid Loop | 1" |
| 1132 | S-Hook | 1" |
| 1133 | Hook Suction Cup | 2"diam. |
| 1134 | Metal Double C-Hook | 18" |
| 1135 | Drywall Mounting Kit | 0.75" |
| 31004 | T-Wing Slatwall Adapter | 1.25" |

Metal Double C-Hook - #1134

Galvanized steel wire for suspended applications.
Colors: Silver
Length: 18"



Ceiling Grid Clip - #1130
Accommodates S-Hooks or Double C-Hooks and clips securely to standard 1" ceiling grid. 1/8" hole accepts most hooks.
Colors: Clr
Length: 1"



Ceiling Grid Loop - #1131
Easy to use design attaches to one side of ceiling grid. 3/16" loop allows easy hook attachment.
Colors: Wht
Length: 1"



S-Hook - #1132
Colors: Silver
Length: 1"



Hook Suction Cup - #1133
Colors: Clear/Silver
Length: 2"diam.



Drywall Mounting Kit - #1135
Colors: Silver
Length: .75"



T-Wing Slatwall Adapter - #31004
Colors: White
Length:



LIGHTS ALIVE



**BACKLIT FLOOR STAND
LIGHT THIEF
SINGLE SIDED LIGHTBOX
DOUBLE SIDED LIGHTBOX
VERSAFLEX MODULAR
FRAME SYSTEM**



**WALLS+
FORMS**

VERSAFLEX

MODULAR FRAME SYSTEM

The VERSAFLEX framing system features high quality low profile aluminum extrusions with hidden connectors. The design profile has both front and side panel applications, unique to the display industry. This allows for designs of an array of different products.

Frames are available in any size to suit. Single or multi panel units come with easy change out of images. They can be freestanding, wall, or ceiling mounted.

THE VERSAFLEX™ FRAMING SYSTEM is used to create cost effective, long lasting product displays. One, two, three and four sided designs are available. Image panels can be illuminated, and are simple to change out. The sides can be back lit for logos.



Our unique extrusion gives us the ability to create practically any design our customers demand.

Our patented profile allows the ability to create a three dimensional design for any situation.

Allows for up to 1/8 inch thick substrate providing the versatile flexibility desired.

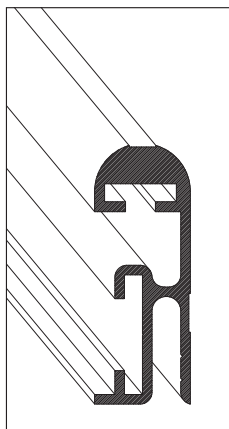

The key to VERSAFLEX is simplicity of design. Printed images can be used in a variety of ways...as a lightbox, light thief, floor stand or poster frame, all using the same high quality aluminum framing. From a lightbox that looks like it's floating on the wall, to a multi-sided product floor display, this system is unique in both cost effectiveness and in-store impact.



SPECIFICATIONS

The Versaflex™ frame is easy to install and is available for the do it yourselfer.

- Top or side loading - promotions switch out in seconds.
- Assembles in a few seconds without the hassle of tools.
- Lightweight aluminum construction.

Available in clear anodized satin or black anodized finish.

The Versaflex™ frame system can be modified for applications such as:

- Single & double sided ceiling-hung menu Boards.
- Wall Mounted Menu Boards
- Free Standing Menu Boards.

All options available in a light box version

LIGHT THIEF

BACKLIT DISPLAYS

Stand out above the crowd. With full 360 degree viewing, this unit steals the existing light from the ceiling fixture.

Easy to install, no tools required. Adjustable brackets attach to the light panel surround. High quality acrylic finish, easy to change out images.

Features include:

- 2 x Die-molded frames, black matte finish, 1 1/8" x 1/2" profile.
- Easy side-loading graphics
- 2 x 040" clear acrylic backer sheets
- Easy to install, no tools required
- Light weight and durable design
- Units can be shipped flat for easy on-site assembly, or pre-assembled in cartons



SPECIFICATIONS

Dimensions:

CMLT1620 – 16 3/4" x 20 5/8" x 25"

CMLT2424 – 24" x 24" x 25"

CMLT1648 – 16" x 48" x 25"

CMLT2448 – 24" x 48" x 25"

Viewable:

CMLT1620 – 15 3/4" x 19 3/4"

CMLT2424 – 23" x 23"

CMLT1648 – 15" x 47"

CMLT2448 – 23" x 47"

Image Installation:

Image is inserted on right side and backed with PETG .040" lens.

Colors/ Finishes:

Black aluminum frame construction, 1/2" slimline profile.

End caps can be printed with logos or advertising message.

Packaging:

Packed flat one unit per carton for easy on site assembly.

Instruction sheet with kit.

Accessories:

8" adjustable ceiling mounting brackets, screws and wing nuts.

| ITEM# | GRAPHIC SIZE |
|----------|-------------------|
| CMLT1620 | 16 1/4" x 20 1/4" |
| CMLT2424 | 23 7/8" x 23 7/8" |
| CMLT1648 | 15 7/8" x 47 7/8" |
| CMLT2448 | 23 7/8" x 47 7/8" |

DOUBLE SIDED LIGHTBOX

BACKLIT DISPLAYS

The Walls+Forms exclusive, Lights Alive double sided lightbox. It catches the consumer's eye with the ability to print illuminated logos on side panels, attracting additional attention from all angles.

The double sided light box features black frames with a profile size of 1 1/8" x 1/2", easy loading graphics, and the ability to be free standing or hanging. They are UL Approved and are designed to accept images in screen printed, digital, or photographic formats.

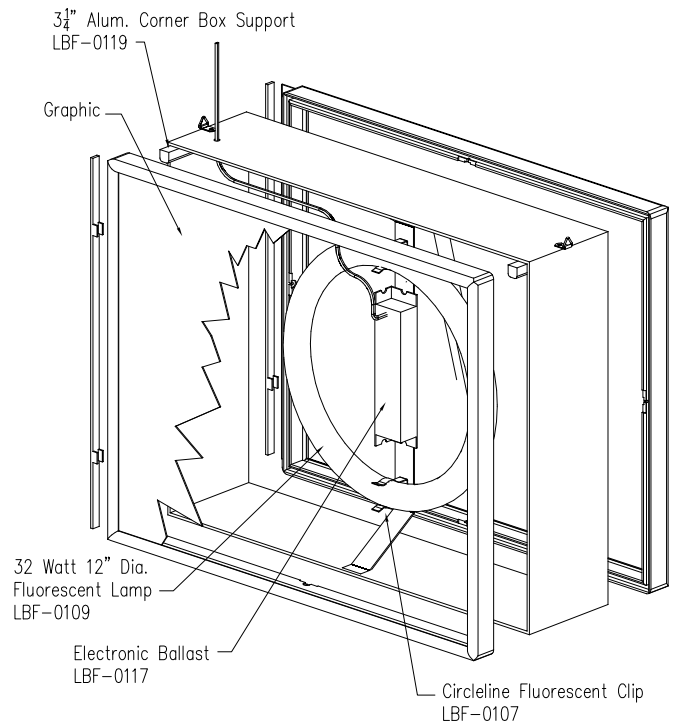
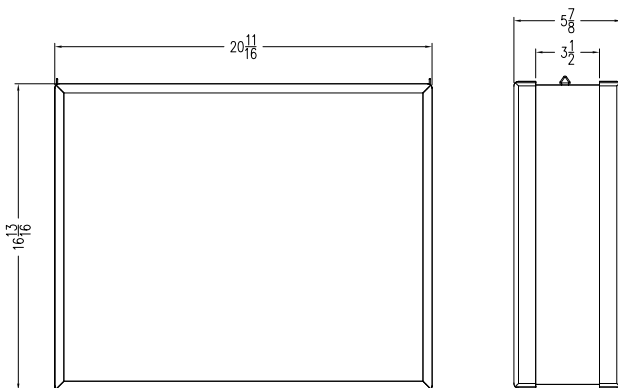

The Walls+Forms modular lightbox series has a stunning visual effect, each of the designs are variable in size and format. Easy to install, units link together on site.

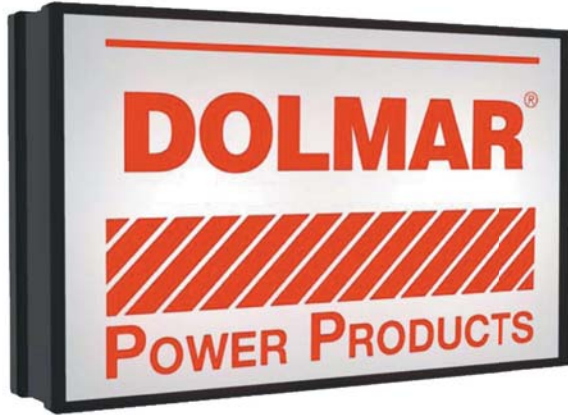

| ITEM# | GRAPHIC SIZE |
|----------|-------------------|
| DSLB1620 | 20 1/4" x 16 1/4" |
| DSLB2424 | 23 7/8" x 23 7/8" |

SPECIFICATIONS

Dimensions:

DSLB1620 – 20 5/8" w x 16 3/4" h x 5 1/2"

DSLB2424 – 24" w x 24" h x 6"

Image Installation:

DSLB1620 – Image is inserted on right side, and backed with clear PETG .040 lens.

DSLB2424 – Image is inserted on top side, and backed with clear .125" acrylic lens.

Colors/ Finishes:

DSLB1620 – Front and back frames are black plastic molded frame with 1/2" slimline front profile.

DSLB2424 – Front and back frames are black aluminum frame with 1/2" slimline front profile.

Top, Bottom and Side:

Lightbox outer shell is White or Black fluted plastic. White acrylic outer is available as an upgrade.

Logo can be applied to all sides for additional promotion of brand or product.

Lighting:

DSLB1620 – 32 watt, 12" Circleline fluorescent tube.

DSLB2424 - 40 watt 16" Circleline fluorescent tube.

Electrical:

Electronic ballast with warranty, 8 ft. black cord set, with on/off switch. UL Approved.

Packaging:

Assembled and packed one unit per carton.

Accessories:

Supplied with 4 x washers and screws for wall mounting.

**Other sizes are available - call for quote.*

SINGLE SIDED LIGHTBOX

BACKLIT DISPLAYS

The Lights Alive single sided light box with it's contour design appears to float off the wall.

The single sided light box features black frames with a profile size of 1 1/8" x 1/2", easy loading graphics, and the ability to be free standing or hanging. They are UL Approved and are designed to accept images in screenprinted, digital, or photographic formats.

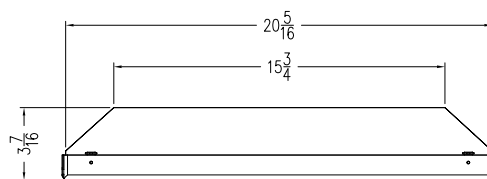
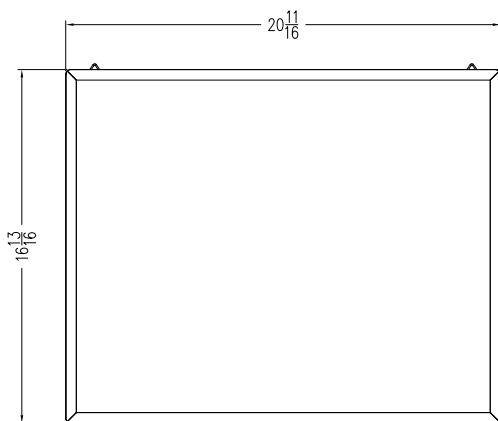
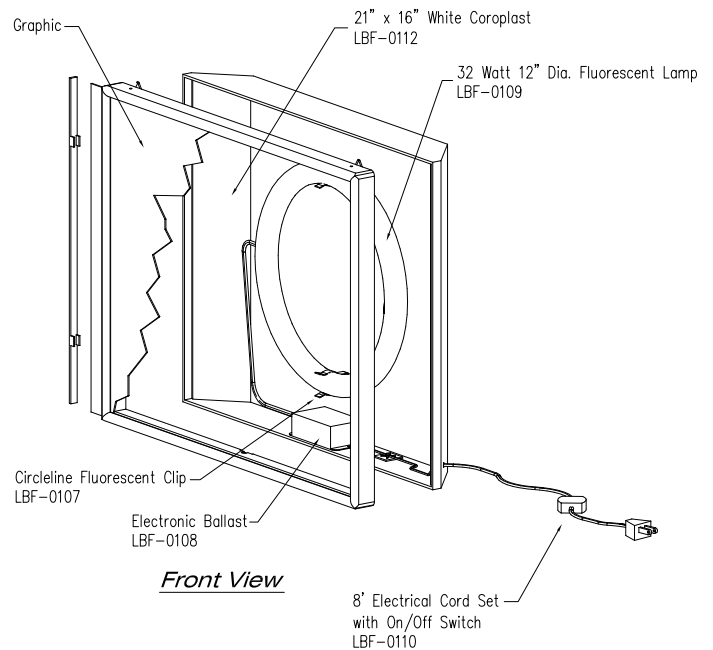
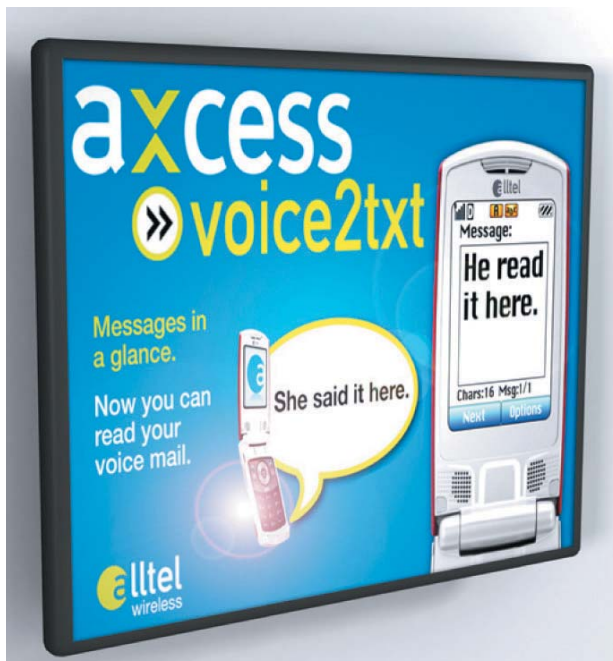

The Walls+Forms modular lightbox series has a stunning visual effect, each of the designs are variable in size and format. Easy to install, units link together on site.



SPECIFICATIONS

Dimensions:

SSLB1620 – 20 5/8" w x 16 3/4" h x 3 1/2"

SSLB2424 – 24" w x 24" h x 3 1/2"

Image Installation:

SSLB1620 – Image is inserted on right side, and backed with clear PETG .040 lens.

SSLB2424 – Image is inserted on top side, and backed with clear .125" acrylic lens.

Colors/ Finishes:

SSLB1620 – Black plastic molded frame with 1/2" slimline profile. 3mm black coroplast outer.

SSLB2424 – Black aluminum frame with 1/2" slimline profile. 3mm black coroplast outer.

Lighting:

SSLB1620 – 32 watt, 12" Circleline fluorescent tube.

SSLB2424 – 40 watt 16" Circleline fluorescent tube.

Electrical:

Electronic ballast with warranty, 8 ft. black cord set, with on/off switch.

UL Approved.

Packaging:

Assembled and packed one unit per carton.

Accessories:

Supplied with 4 x washers and screws for wall mounting.

| ITEM# | GRAPHIC SIZE |
|----------|-------------------|
| SSLB1620 | 20 1/4" x 16 1/4" |
| SSLB2424 | 23 7/8" x 23 7/8" |

BACKLIT FLOOR

STAND DISPLAYS

We offer a range of cost effective versatile floor stands, illuminated or non-lit. A definite highlight in any retail, banking, or trade show environment. Available in two, three and four sided formats. Featuring slatwall panels for hanging merchandise or literature, and easy change out of advertising images.

Our exclusive aluminum framing system is high quality and low profile. Black is the standard color, with alternatives available. The simplicity of design allows for matching to any store decor, or corporate color scheme. Marble, granite, wood grain, whatever you need.



SPECIFICATIONS

Dimensions:

DSFS7622 – 76"h x 22 1/8"w x 6" deep

DSFS8424 – 84"h x 24"w x 6" deep

Print insert:

Image is inserted on top side. 2 clear acrylic insert sheets, 1/8" backer and .040" front.

Colors/ Finishes:

Black aluminum frame construction, 1/2" front profile.

Standard outer finish, black MDF.

Bottom Section:

DSFS7622 – 48"x 22" standard black MDF finish. Slatwall upgrades are available at extra cost.

DSFS8424 – 48"x 24" standard black MDF finish. Slatwall upgrades are available at extra cost.

Base supports are 3/4" MDF.

Lighting:

DSFS7622 – 40 watt Circleline fluorescent tube.

DSFS8424 - (2) 40 watt Circleline fluorescent tubes.

Electrical:

Electronic ballast with warranty, 8 ft. black cord set, without on off switch. UL Approved.

Packaging:

Assembled and packed one unit per carton. Shipped on pallet.

| ITEM# | GRAPHIC SIZE |
|----------|---------------------|
| DSFS7622 | 22"w x 28"h |
| DSF8424 | 23 7/8"w x 35 3/4"h |

CONFIGURATIONS

Walls + Forms can design a product display that fits your specific need. Our system is unique in both simplicity and versatility. Let us show what we can do to make your product stand out.

Triangle Floor Stand

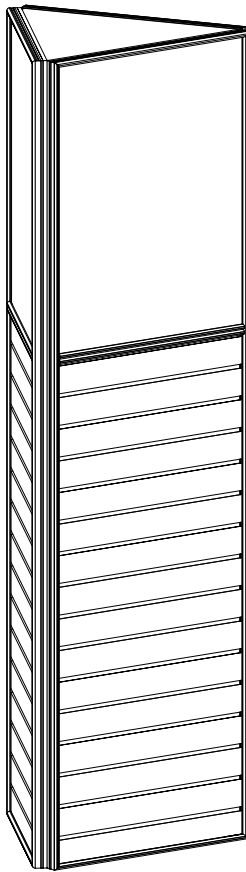

76"x22" Triangle Floor Stand,
28"x22" images on all sides.
Pedestal base panels can be adapted
to suit your needs. High quality aluminum
framing completes the look.

Double Sided Floor Stand

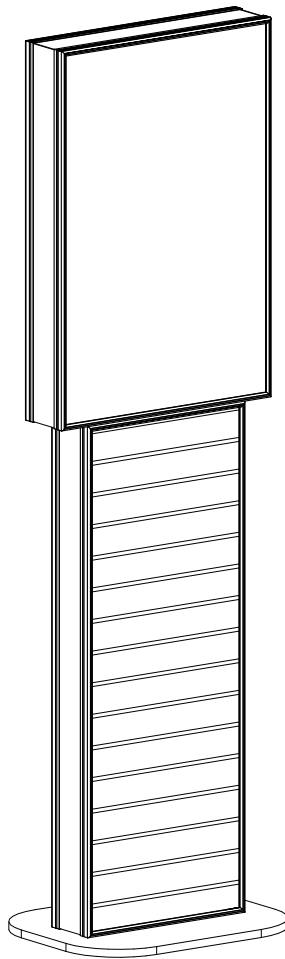

84"x24" Double Sided Floor Stand,
36"x24" images both sides.
Options include illuminated side
logo panels. Units can be design to
match store décor.

Triangle Floor Stand

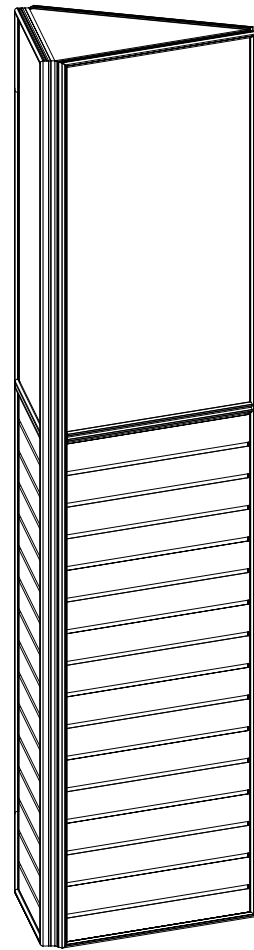

84"x24" Triangle Floor Stand,
36"x24" images on all sides.
Catches attention from all angles.
Image area can include permanent
logo panels. A great merchandising
display.



STORE FIXTURING | P.O.P. | SIGNAGE | COMPONENTS | CUSTOM

P. 972.745.0800 WWW.WALLSFORMS.COM

P.O. BOX 741112 | DALLAS, TEXAS 75374-1112

FACTORY: 204 AIRLINE DRIVE, BLDG. 200 | COPPELL, TEXAS 75019