



STORE DISPLAY CATALOG

OUR STORY.

Founded in 1986, Walls+Forms started as a designer and manufacturer of display components for builders and specifiers across the globe. A few short years later, at the request of our end users, we expanded our capabilities to include assembly and fabrication utilizing our core products. This vehicle became a spring board for many new concepts in display engineering that still serve as the cornerstone of who we are today.

CONTINUES...

We now design and manufacture a diverse and growing portfolio of retail fixtures, point-of-purchase displays, store packages, extrusion components, signage systems and much more. We are in a unique position of servicing the retailer, product manufacturer, OEM, contractor and distributor. This expertise allows us the ability to create an ensemble of displays crafted to your exact specifications while maintaining a strict discipline of controlling costs.

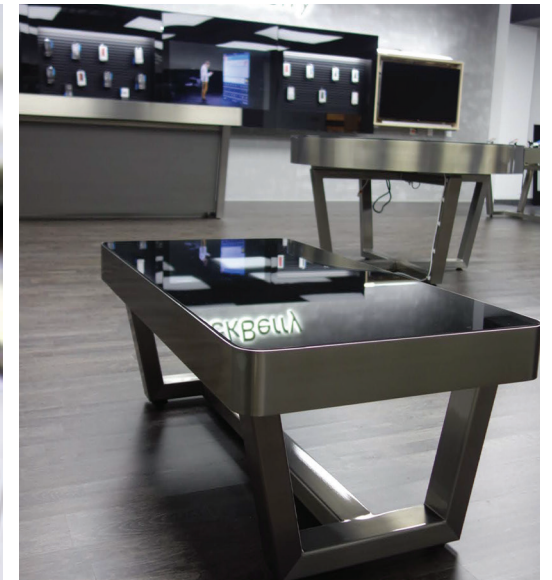

SIMPLICITY.

There are no complicated parts to worry about. Our system eliminates assembly errors, mis-ordering and high inventory costs. Each display consists of minimal components. Panels, panel fastening trims and accessory options come completely from one source, Walls+Forms. Panels snap together in minutes and full merchandising can be accomplished in a few hours.

AFFORDABILITY.

Part standardization permits low prices with low minimum quantity. High construction costs, mess and lengthy time delays are eliminated.

EASE OF ASSEMBLY.

Each display format has been designed for ease of assembly by non-construction personnel. Either you, store personnel or a contractor can assemble each system with ease! To reduce assembly time, detailed assembly instructions are included with your display.

VALUE ADDED. CLIENT SERVICES TEAM.







T2 frames attach to existing wall or back-2-back for free-standing unit.



reference T2 applications for more examples



Simplicity of Parts

Ships flat (RTA). Assembles in minutes!

Available Accessories:

shelves, back-lit headers, brackets, hooks, cabinets, end-plates and more!

T2+ Modular Wall (Full Frame)

Part Number: PG-WL-0290

Overall Dimensions:

41(L) x 6.375"(W) x 93"(H)

FEATURES:

- Light-weight, structural, and sleek frame system
- Clean, effective wire management solution
- Effortlessly change out plates & colors
- Countless configuration and color options
- Quick and easy installation with minimal labor

OPTIONS:

- Standard plate heights include 12", 25.625" & 39"
- Standard plate colors are White, Black, Gray, Hardrock Maple, Walnut & Cherry
- Add extensions to add height to frame sections

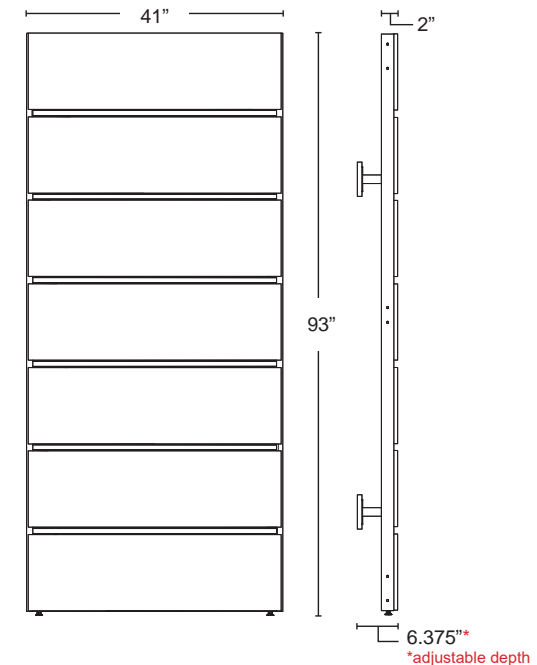

modular. modern. must have.



T2 Floor Display (H-Unit)

Part Number: PG-DN-0143

Overall Dimensions:

136(L) x 42.5"(W) x 93"(H)

FEATURES:

- Light-weight, structural, and sleek frame system
- Clean, effective wire management solution
- Effortlessly change out plates & colors
- Countless configuration and color options
- Quick and easy installation with minimal labor

OPTIONS:

- Standard plate heights include 12", 25.625" & 39"
- Standard plate colors are White, Black, Gray, Hardrock Maple, Walnut & Cherry
- Add extensions to add height to frame sections

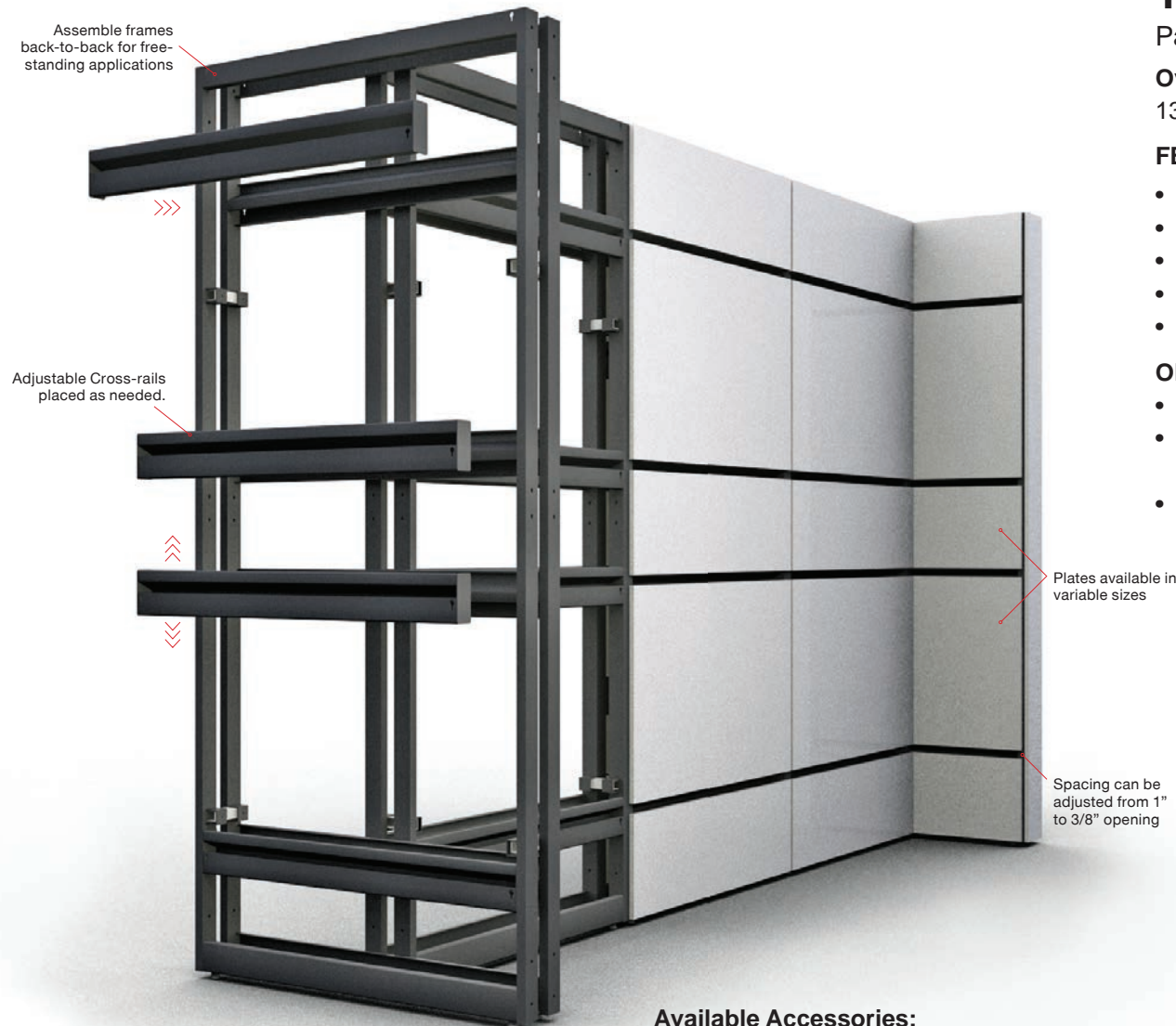

Available Accessories:

shelves, back-lit headers, brackets, hooks, cabinets, end-plates and more!

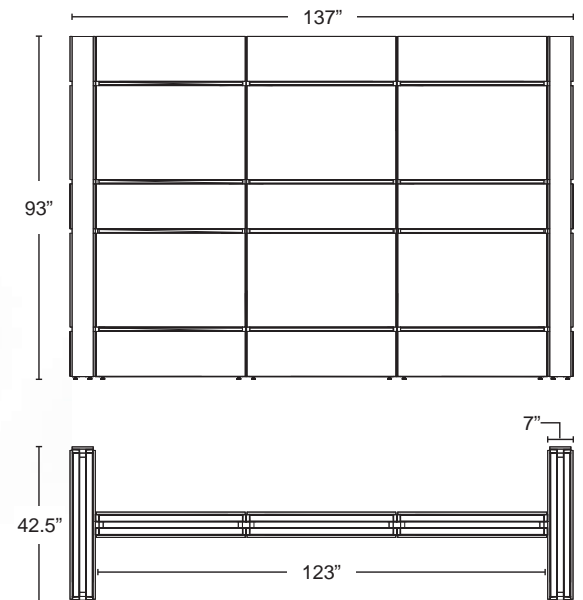

free-form. functional. fabulous.

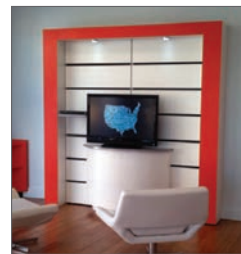



T2 Canopy, Column & Base Deck

Part Numbers: Outside Column = PG-CL-0015 / Inside Column = PG-CL-0016 / Canopy = PG-HD-0008 / Base Deck = PG-BD-0015

FEATURES:

- Add dimension and attention for featured products.
- Modular components = countless configurations.
- Mix and match to create your desired look.

OPTIONS:

- Standard colors are white, black, gray, hardrock maple, walnut & cherry.

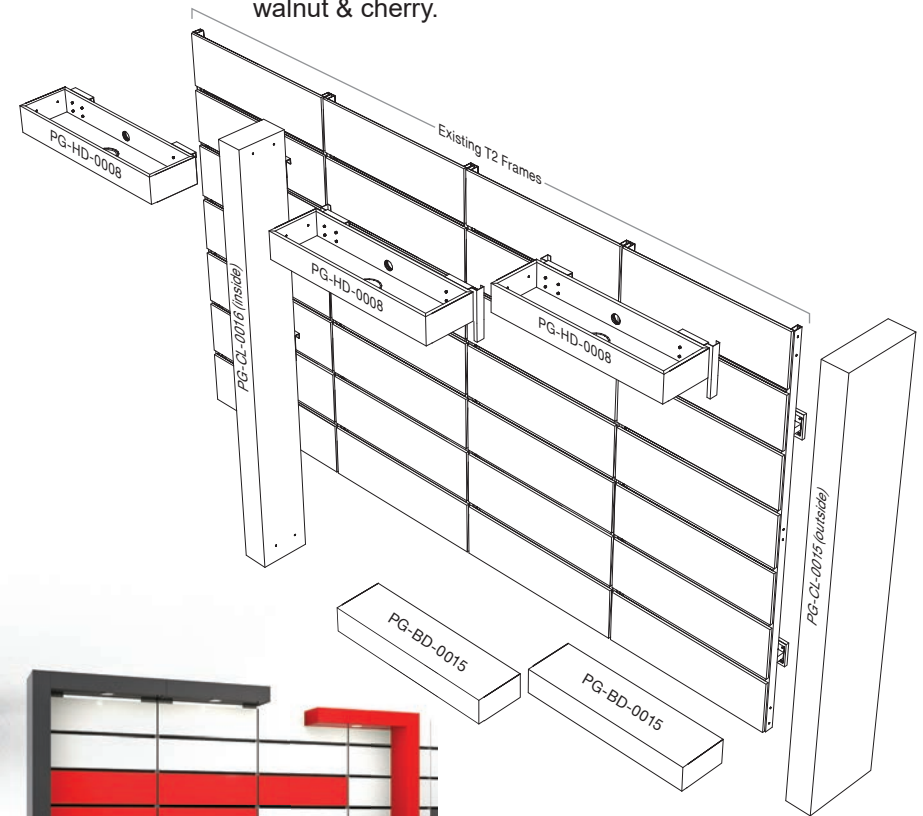

Modular Design = OPTIONS!
reconfigure to create unique looks.

better. bold. beautiful.



Linear Shop-in-Shop

Part Number: EX-0079



Electronics Island w/ Storage

Part Numbers: FD-0567A, FD-0567B, FD-0567C

Overall Dimensions:

133.25"(L) x 42.5"(W) x 79"(H)

FEATURES:

- 3-section modular design. (table, endcap & tower)
- High-impact, durable horizontal surfaces.
- Slots for security devices + wire management.
- Secured tower for stocking products.
- Branded tower with back-lit header and graphics.

OPTIONS:

- Standard colors for vertical surfaces are white, black, gray, hardrock maple, walnut & cherry. Ability to re-configure or expand as needed.



- A** = FD-0567A (Table)
- B** = FD-0567B (Endcap)
- C** = FD-0567C (Tower)

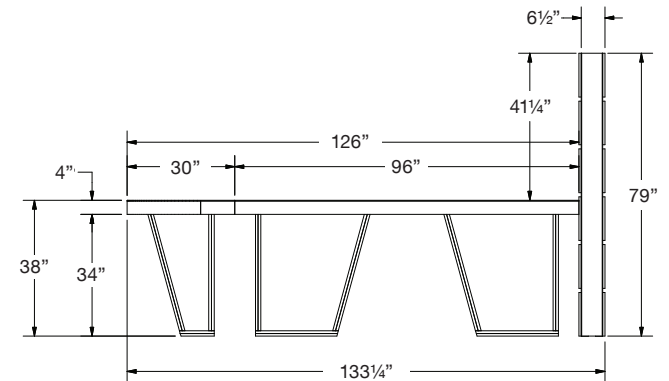
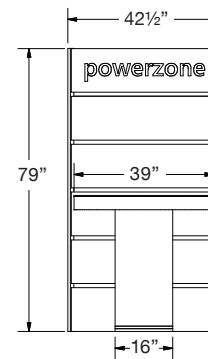
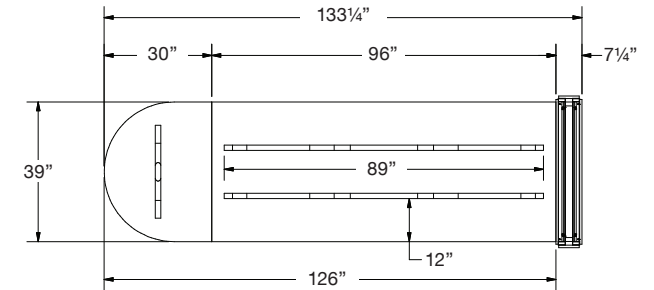

sleek. savvy. solid.

T2 Display System | Add-Ons:

T2 VersaFlex Header

Part #: SG-0183
 Dims: 41.5"w x 12" x 3.5"

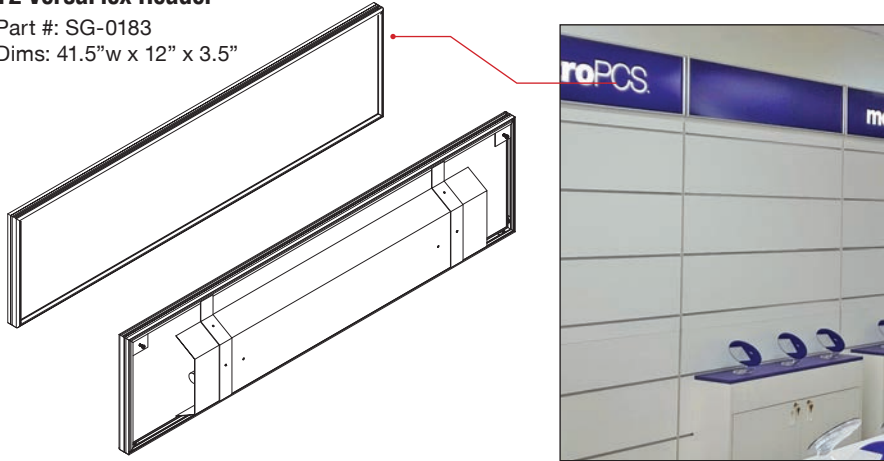

T2 Reverse Acrylic Logo*

Part #: D1-TV-WH-41
 Dims: 41.5"w x 12" x 0.5"
 *minimums apply

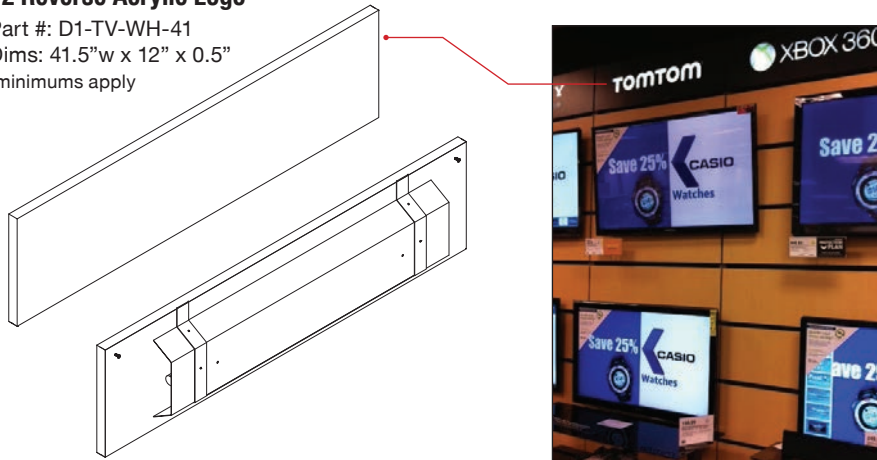

Single Plate for Full Frame
 Part #: PG-FP-0007
 Dims: 40.5" x 12"



Double Plate for Full Frame
 Part #: PG-FP-0009
 Dims: 40.5" x 25.625"

Triple Plate for Full Frame
 Part #: PG-FP-0010
 Dims: 40.5" x 39"

Single Plate for Half Frame
 Part #: PG-FP-0002
 Dims: 20" x 12"



Double Plate for Half Frame
 Part #: PG-FP-0004
 Dims: 20" x 25.625"

Triple Plate for Half Frame
 Part #: PG-FP-0005
 Dims: 20" x 39"

End-Plate
 Part #: PG-EP-0001
 6" x 93"



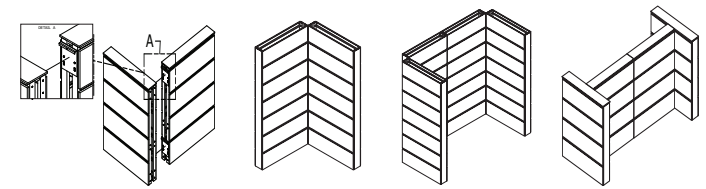
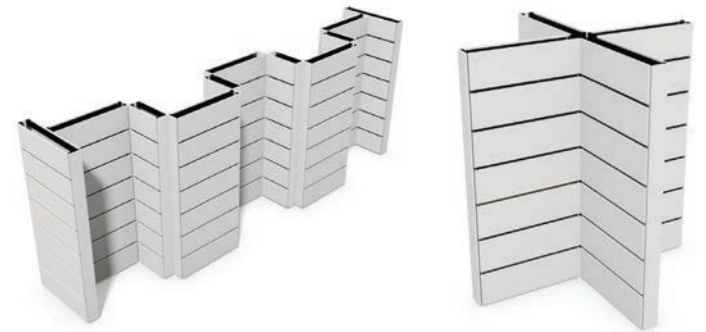



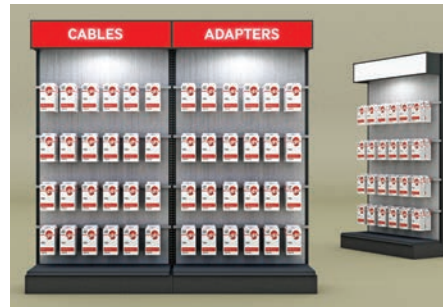
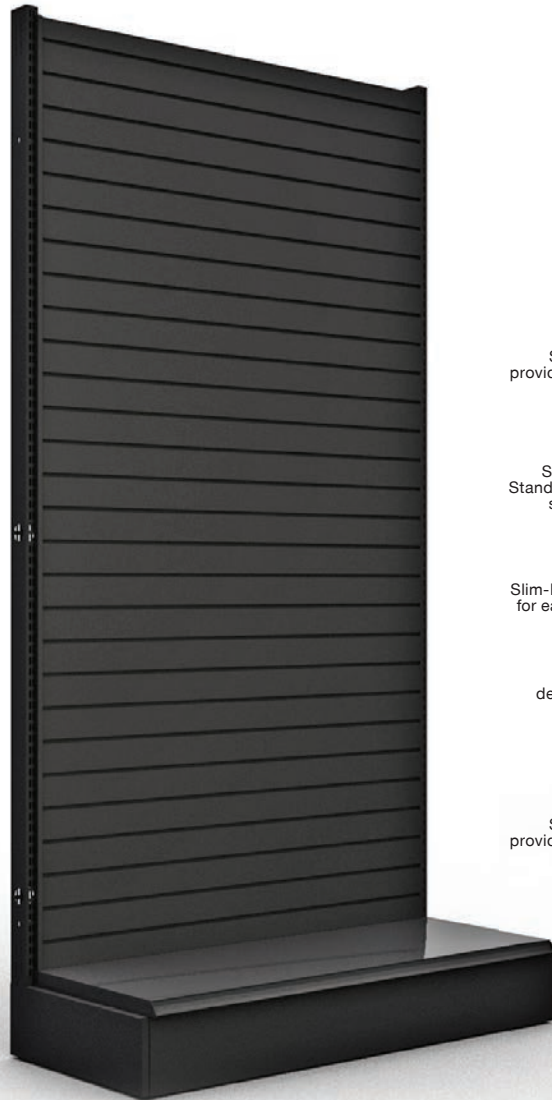

Slim-Line Display Unit (Starter)

Part Number: FD-0556-SW (Slatwall)

Overall Dimensions:

49.5"(L) x 95"(H) x 21"(D)

FEATURES:

- Free-standing, solid metal frame.
- Quick and easy installation and change outs.
- Can be setup individually or in a series.
- Flexibility to move away from wall and reconfigure

OPTIONS:

- Frame is available in Black & White Finish
- Panel options include: Slatwall, Solid, Slat-Grid and/or Full Graphic Background.
- Standard panel colors are White, Black, Gray, Hardrock Maple, Walnut & Cherry



Simplicity of Parts

Ships flat (RTA). Assembles in minutes!

Available Accessories:

shelves, back-lit headers, brackets, hooks, cabinets, end-plates and more!

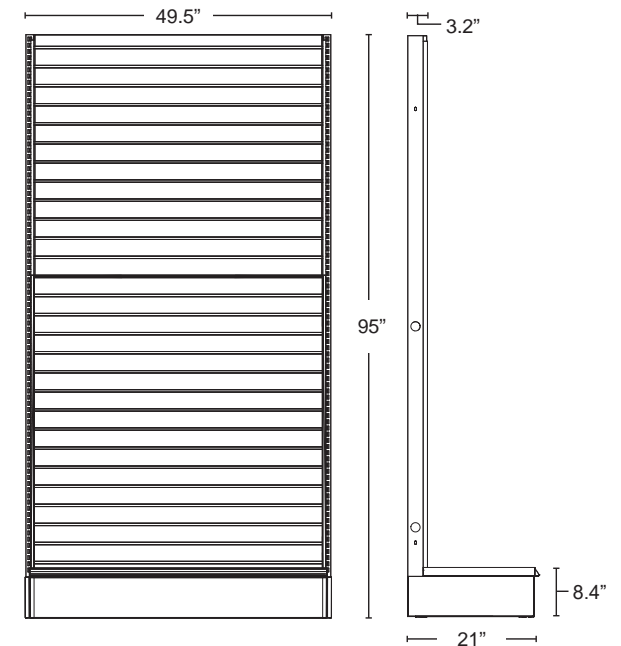

simple. structural. stylish.



Sample Application Reflects:

- (2) Slim-Line Floor Gondolas
- (2) 36" Slim-Lin End-Caps
- (4) end-plate add-ons
- (3) Optional Headers Plates



Slim-Line Floor Gondola (Starter)

Part Number: FD-0734-SW (Slatwall)

Overall Dimensions:

49.5"(W) x 54"(H) x 38"(D)

FEATURES:

- Used in conjunction with Slim-Line Endcap (FD-0561)
- Free-standing, solid metal frame.
- Quick and easy installation and change outs.
- Can be setup individually or in a series.
- Flexibility to reconfigure and expand as needed.

OPTIONS:

- Frame is available in Black & White Finish
- Panel options include: Slatwall, Solid, Slat-Grid and/or Full Graphic Background.
- Standard panel colors are White, Black, Gray, Hardrock Maple, Walnut & Cherry

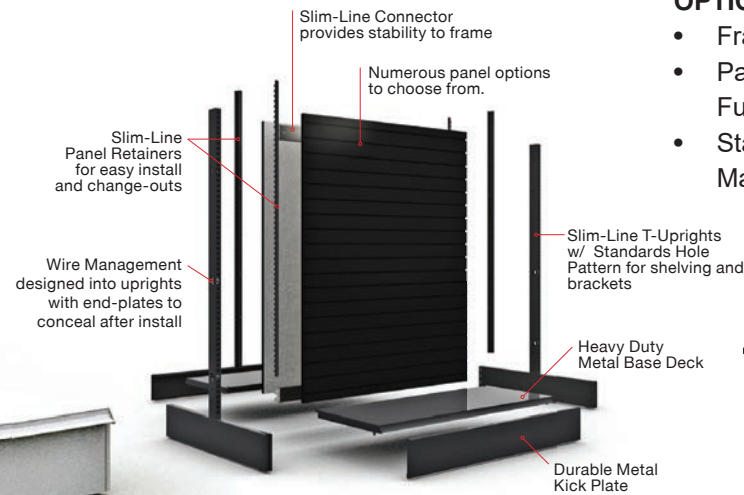

Simplicity of Parts

Ships flat (RTA). Assembles in minutes!

Combine w/
36" EndCap to
create 360°
merchandise

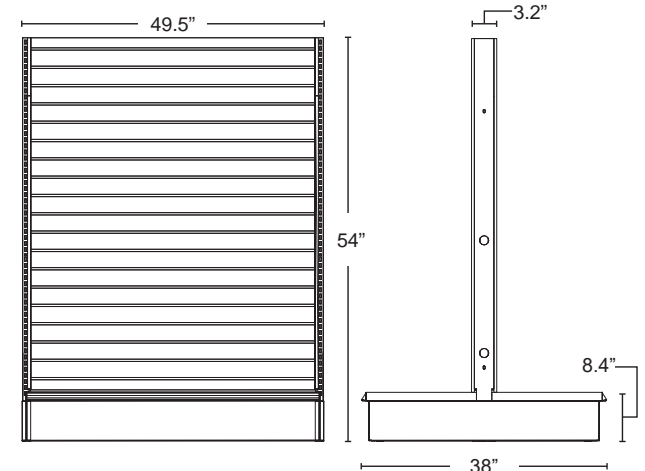

Available Accessories:

shelves, back-lit headers, brackets, mega-bar, hooks, end-caps. (see accessories page)

simple. sleek. stylish.





reference Slim-Line applications for more examples

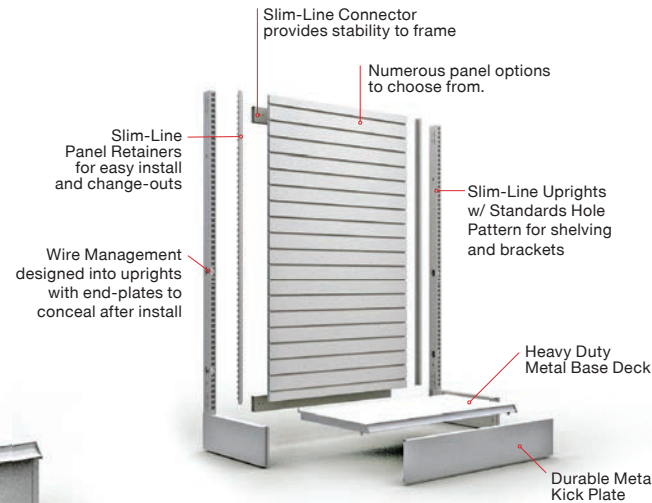

Simplicity of Parts
Ships flat (RTA). Assembles in minutes!

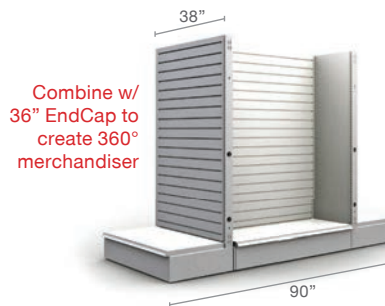

Slim-Line 36" End-Cap (Starter)

Part Number: FD-0735-SW

Overall Dimensions:

37.5"(W) x 54"(H) x 21"(D)

FEATURES:

- Used in conjunction with Slim-Line Gondola (FD-0560)
- Free-standing, solid metal frame.
- Quick and easy installation and change outs.
- Can be setup individually or in a series.
- Flexibility to reconfigure and expand as needed.

OPTIONS:

- Frame is available in Black & White Finish
- Panel options include: Slatwall, Solid, Slat-Grid and/or Full Graphic Background.
- Standard panel colors are White, Black, Gray, Hardrock Maple, Walnut & Cherry

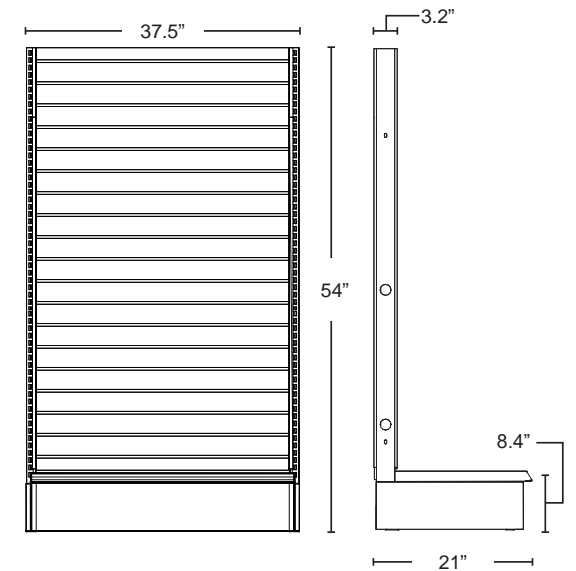

Available Accessories:

shelves, back-lit headers, brackets, mega-bar, hooks, end-caps. (ref. accessories page)

simple. sleek. stylish.

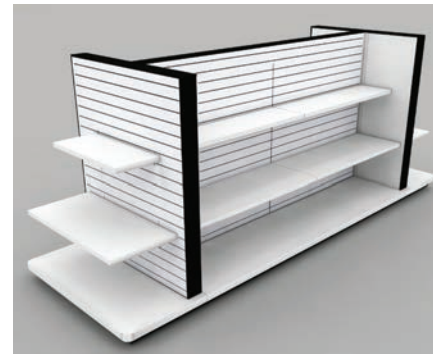

Slim-Line Display System | Add-Ons:

Slim-Line LightBox Header

Part #: SG-0119
Dims: 48" x 9" x 4"

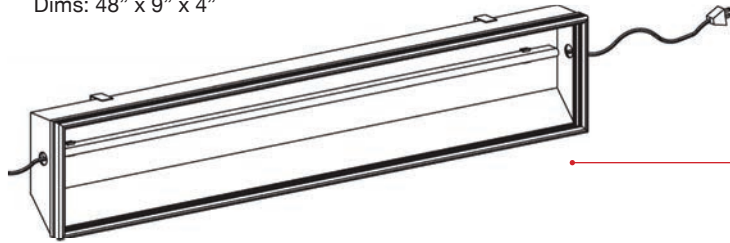

End-Plate for Slim-Line 36" Endcap

Part #: PNL-0292
Dims: 21" x 95" x 0.75"

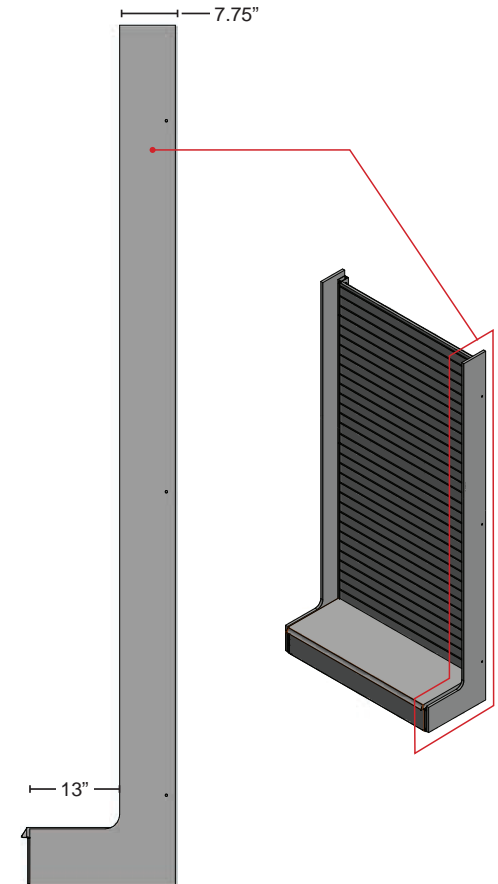

End-Plate for Slim-Line Floor Gondola

Part #: PNL-0290
Dims: 38"w x 55" x 0.75"

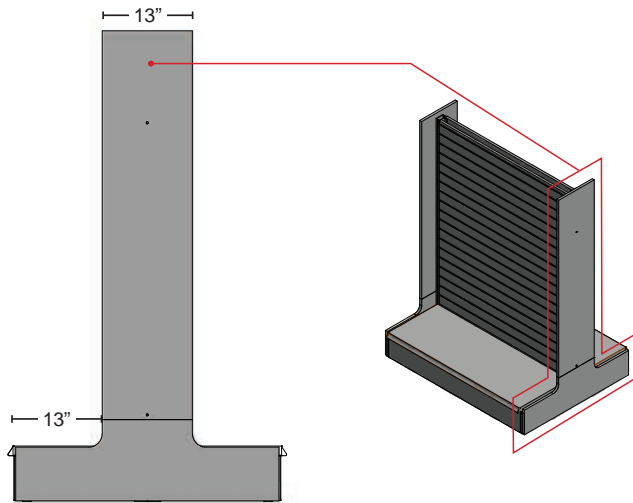

End-Plate for Slim-Line 36" Endcap

Part #: PNL-0291
Dims: 21" x 55" x 0.75"

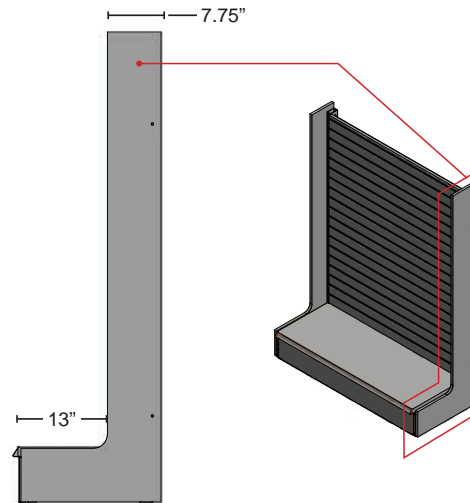



Standard POS Counter

Part Number: CN-1006

Overall Dimensions:

48"(L) x 30"(W) x 45.5"(H)

FEATURES:

- 1 locking drawer
- 1 locking door
- Two tone Frosty White CPU & Printer storage
- Vented grommets
- Check writing ledge

OPTIONS:

- Choose from standard colors for top ledge
- Optional logo panel front of counter
- Standard colors are white, black, gray, hardrock maple, walnut & cherry.

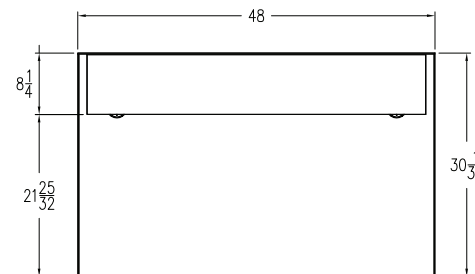

TOP VIEW

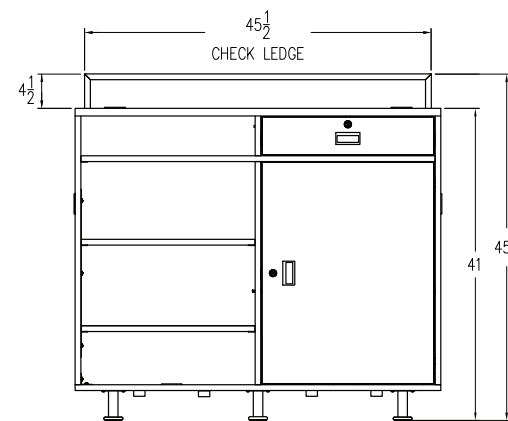

FRONT VIEW

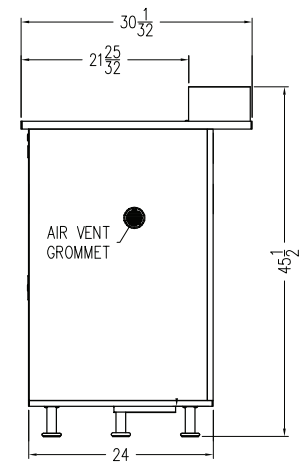

RIGHT VIEW

mix. match. mingle.

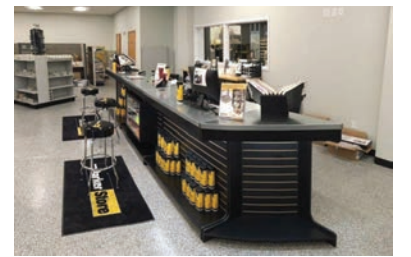

Modular POS Counter System

Part Numbers: CN-0445, CN-0447, CN-0448

FEATURES:

- 3-section modular design allows for countless configurations and layouts.
- Recessed slatwall panels for merchandising.
- Under-counter lighting on front counter ledge.
- Durable construction w/ HPL counter tops
- Adjustable shelves for POS system and printer.
- Access points between counters for wire management

OPTIONS:

- Standard colors are white, black, gray, hardrock maple, walnut & cherry.
- Incorporate logos band to front ledge (as pictured)
- Accent w/ slat-wall groove strips (as pictured)
- Add colored base for additional branding (as pictured)

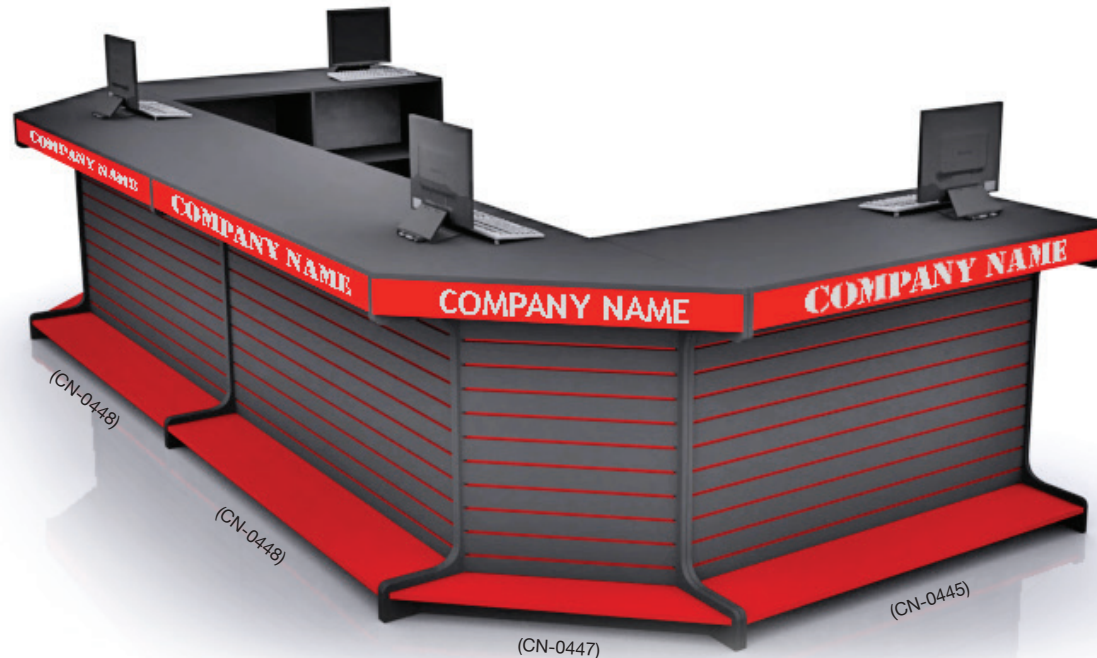

6' Counter Section (CN-0448)

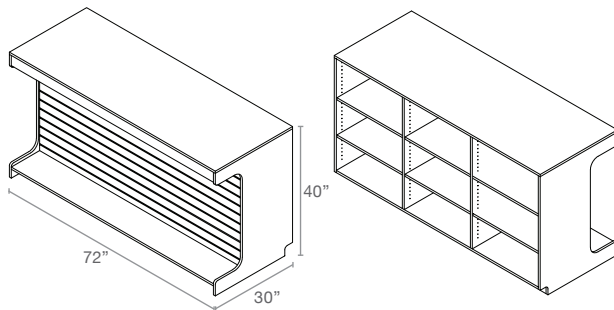

Corner Unit Section (CN-0447)

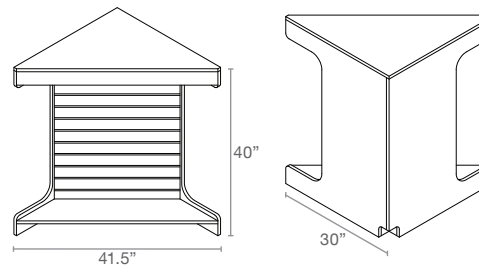

4' Counter Section (CN-0445)

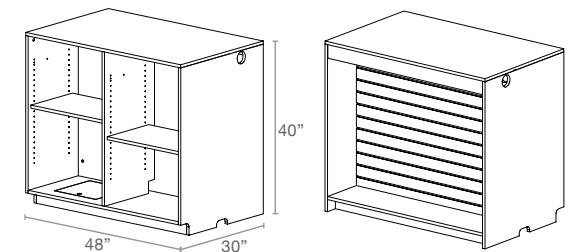

mix. match. mingle.

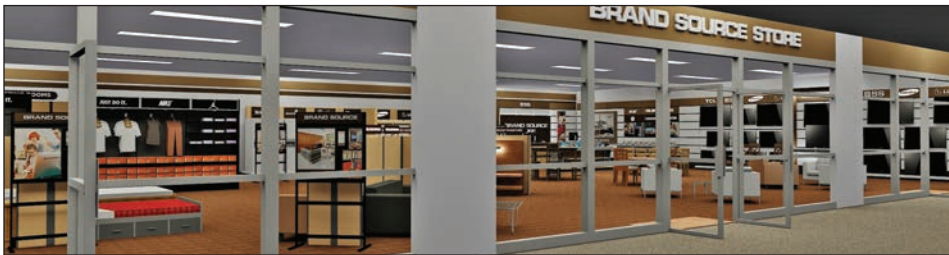



Sample Application Reflects:

- (6) Appliance Stackers
- (2) T2 Full-Frames w/ Plates
- (2) VersaFlex Headers
- (4) End-Plates

Appliance Stacker Display

Part Number: CN-0918

Overall Dimensions:

30"(L) x 26"(W) x 72.75"(H)

FEATURES:

- 1 locking drawer
- 1 locking door
- Two tone Frosty White CPU & Printer storage
- Vented grommets
- Check writing ledge

OPTIONS:

- Choose from standard colors for top ledge
- Optional logo panel front of counter
- Standard colors are white, black, gray, hardrock maple, walnut & cherry.

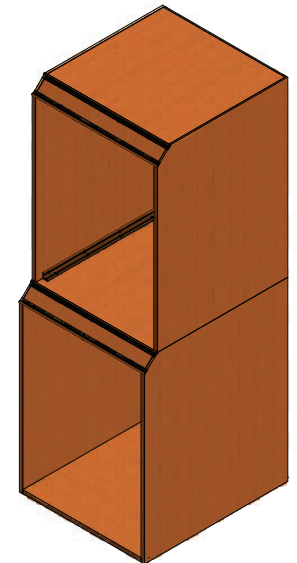
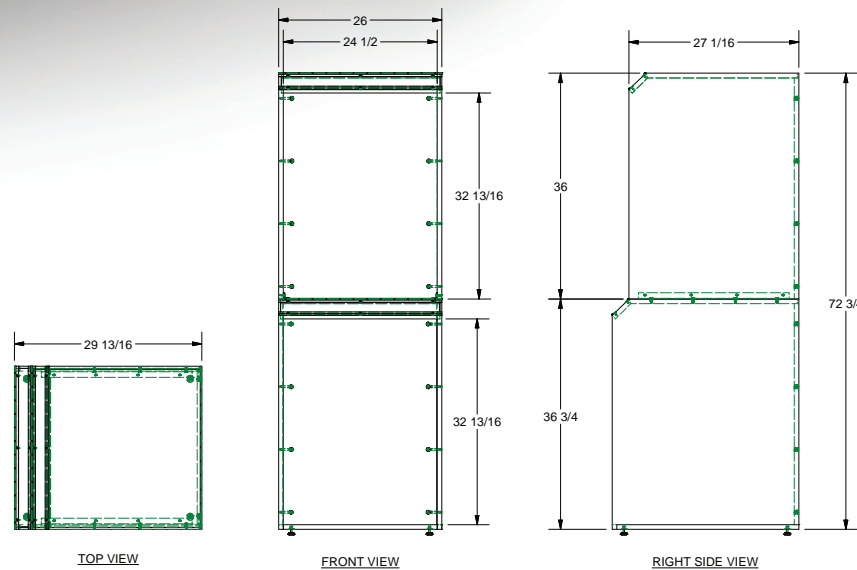

save space. sell more.



Divider & Partition Walls

Part Number: WD-0557 (as pictured)

Overall Dimensions:

14ft.(W) x 5ft.(H) x 5ft.(D)

FEATURES:

- Snap-together panel connector system
- No messy construction and saves space
- Modular and can be reconfigured as needed
- Double-wall option for wire management
- Variable height and width options available.

OPTIONS:

- Choose from standard or custom panel colors
- Add decorative moulding and end-panels
- Optional logo headers and graphics
- Standard colors for connectors are white, gray, almond and black.

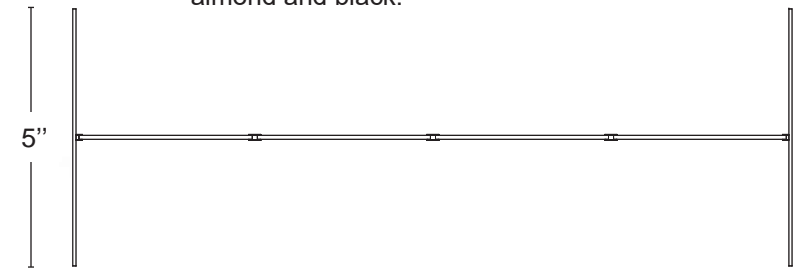
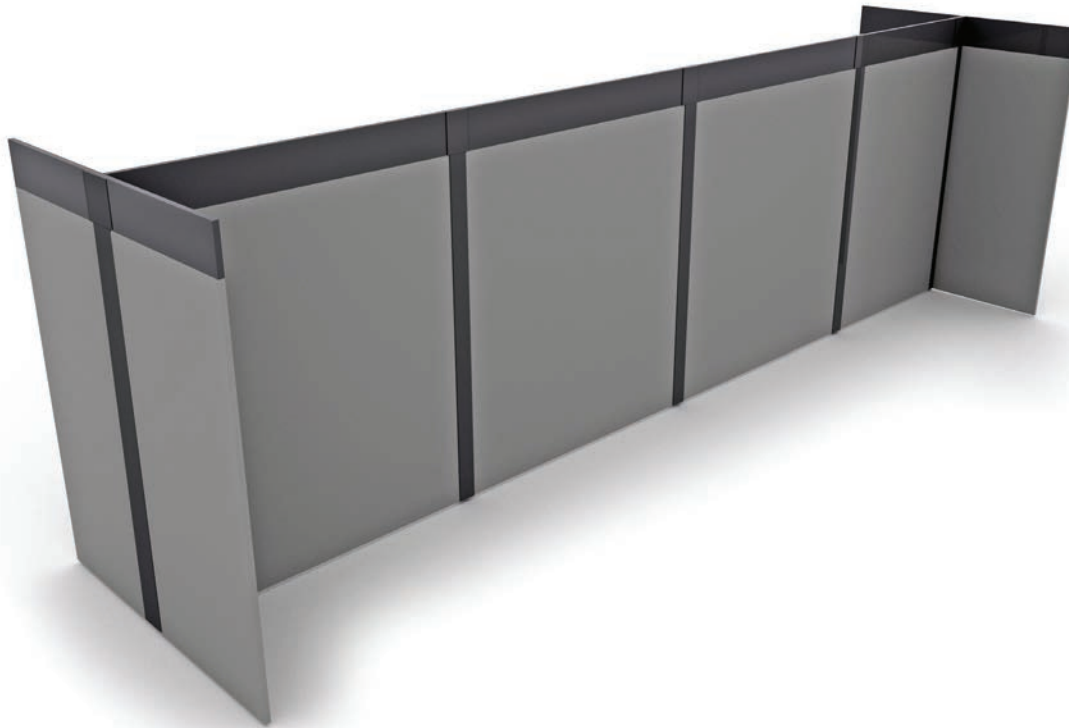

TOP VIEW

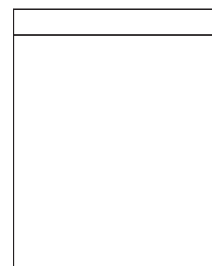

SIDE VIEW

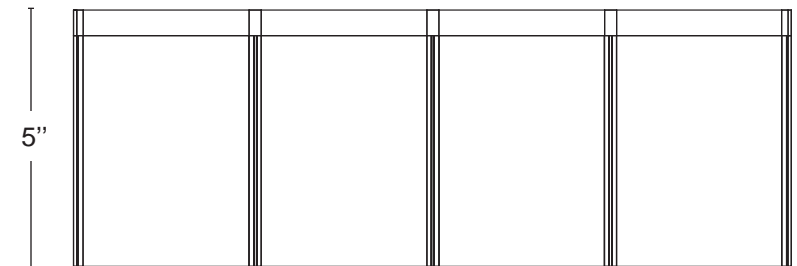

FRONT VIEW

divide and conquer.

Modular Dividing Walls

Designed to fit ANY SIZE space or layout

BENEFITS:

- Quick & easy assembly; no tools required!
- Add walls, offices and storage to any space.
- No construction mess or permits required.
- Flexibility to relocate to other sites.

FEATURES:

- Snap-fit panel connectors for ease of assembly.
- All panels arrive ready to assemble.
- Solid or slatwall face with adjustable shelves on backside.
- Durable, commercial grade surfaces.
- Wire access for electrical and cables.

OPTIONS:

- Various color and finish options available.
- Custom logo and graphic panel upgrades.
- Custom colors & patterns* (*minimums apply*)

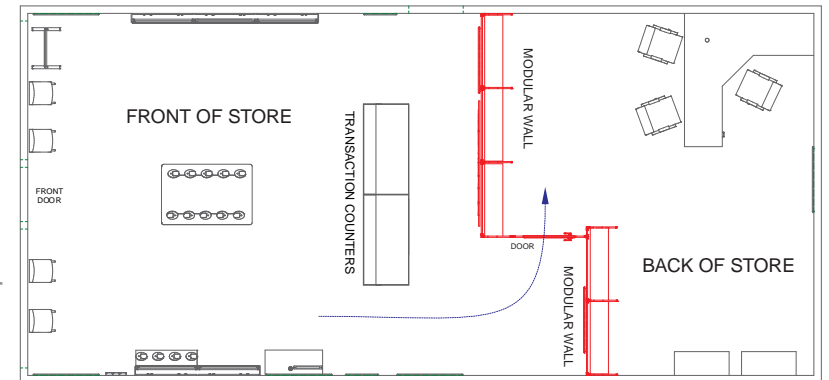
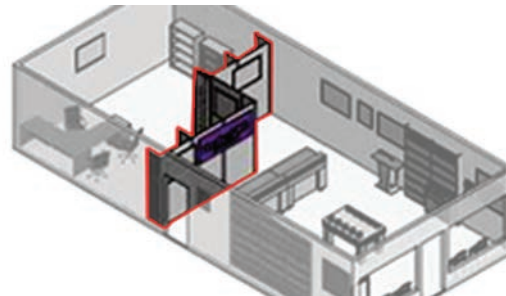

Walk Around with Door

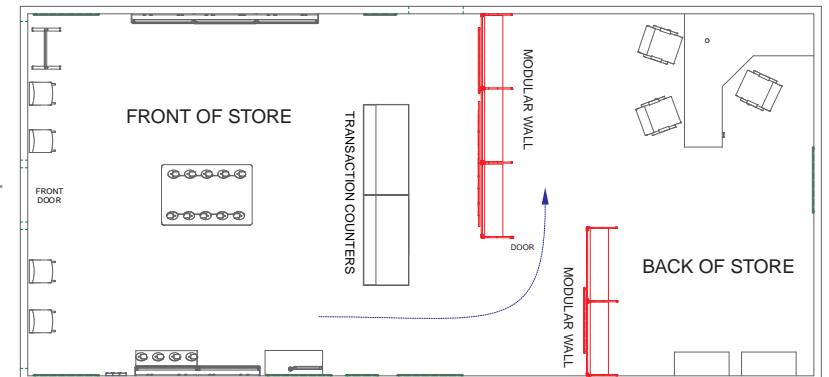

Walk Around

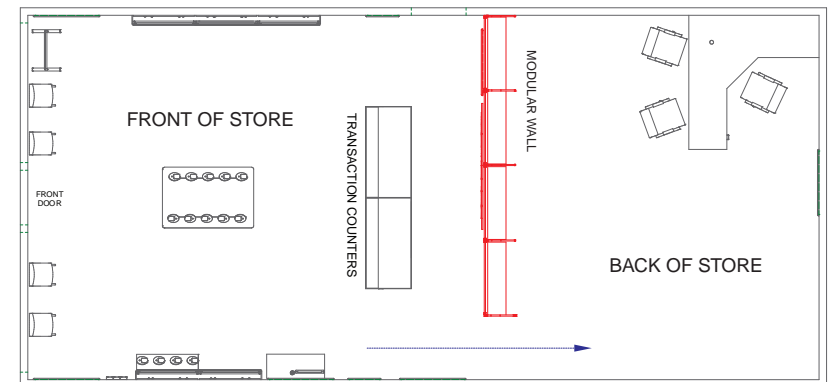

Walk Thru



MODULAR WALLS = OPTIONS

Wall panels are made of solid, 3/4" MDF Panels, with Maple Wood Grain Finish to match your fixtures. Choice of solid or slatwall front face.

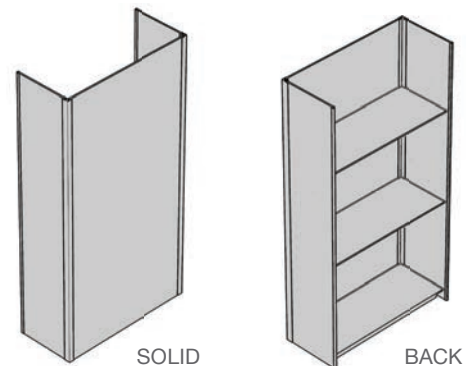
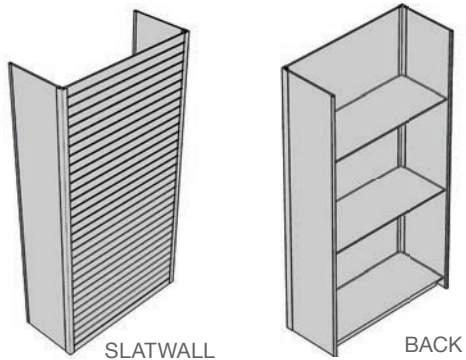

- 8' Tall Wall Sections
- 2', 3' & 4' Widths per Section
- Solid 3/4" MDF Panels
- Panel Connectors (5 standard colors)
- Hardrock Maple LPL Surfaces
- Includes Base Plate & (2) Shelves

STANDARD SIZES: 48" / 36" / 24"(w) x 96"(h) x 18(d)

UPGRADES:

DESCRIPTION:

SPECIFICATIONS:



DOOR PANEL

Door frame with pre-hung, hinged swing door with threshold. All surfaces finished with Hardrock maple. Includes keyed door knob.

DIMS: 48"(w) x 96"(h) x 18(d)

- 8'(h) x 4'(w) Wall Section
- Solid 3/4" MDF Panels
- Serengeti Panel Connectors
- Hardrock Maple LPL Surfaces
- Satin Aluminum Door Frame
- 36" x 80" Solid Core Door

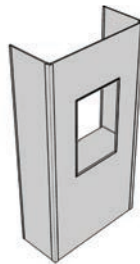

WINDOW PANEL

Modular wall section with framed window. Window panel is clear 1/4" acrylic, framed on all four sides. Includes base plate & (1) adjustable shelf.

DIMS: 48"(w) x 96"(h) x 18(d)

- 8'(h) x 4'(w) Wall Section
- Solid 3/4" MDF Panels
- Panel Connectors (5 standard colors)
- Choose from variety of colors/finishes.
- AVAILABLE WINDOW SIZES
36"x 36" / 24"x 36" / 24"x 24"

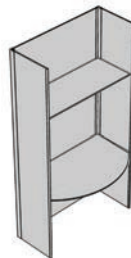

WORKSTATION INSERT

Modular wall section with workspace integrated into backside of wall. Curved desk offers sufficient space and leg room for workstation.

DIMS: 48"(w) x 96"(h) x 30(d)

- 8'(h) x 4'(w) Wall Section
- Solid 3/4" MDF Panels
- Panel Connectors (5 standard colors)
- Choose from variety of colors/finishes.
- 48" x 30" Surface Area



CABINET INSERT

Modular wall section with locking cabinet insert. Door section incorporates existing base panel and shelf to create functional, secured cabinet.

CABINET DIMS: 48"(w) x 38"(h) x 18(d)

- 8'(h) x 4'(w) Wall Section
- Solid 3/4" MDF Panels
- Panel Connectors (5 standard colors)
- Choose from variety of colors/finishes.
- 32"x 48" x 18" inside storage
- Locking doors

W A L L S + F O R M S

Questions? ... Need More Information? ... Contact Us Today!

info@wallsforms.com | 972-745-0800 | www.wallsforms.com

204 Airline Drive | Suite 200 | Coppell TX 75019

W W W . W A L L S F O R M S . C O M